

# FLOORPLANS & CAPACITIES

International Convention Centre Wales

[iccwales.com](http://iccwales.com)

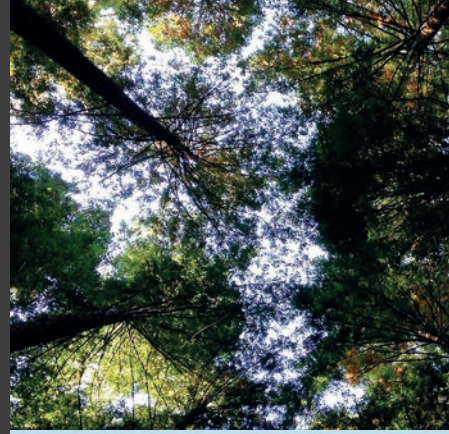

# GROUND FLOOR

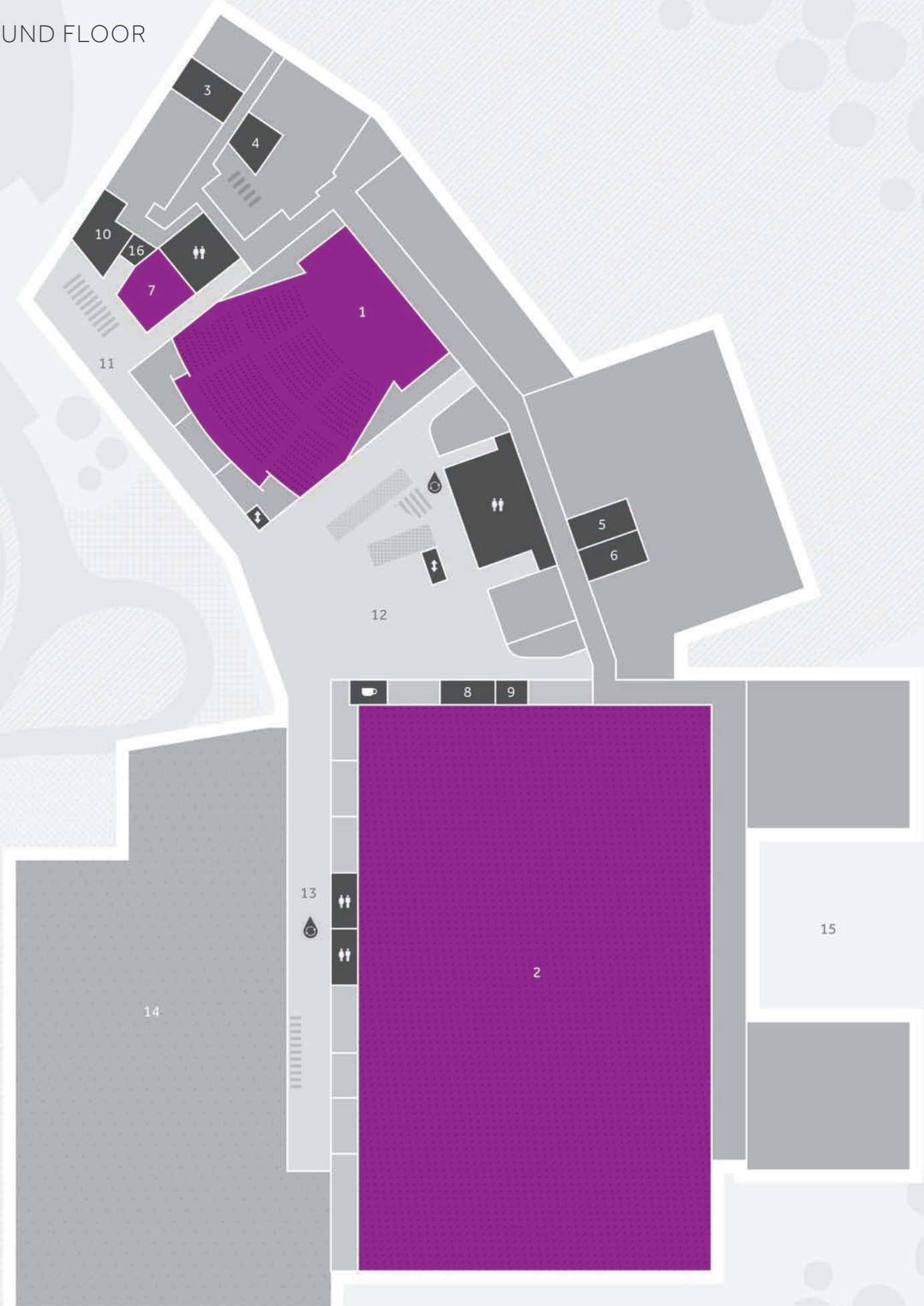

- |   |                |    |                        |
|---|----------------|----|------------------------|
| 1 | Auditorium     | 9  | Medical room           |
| 2 | Main hall      | 10 | Business centre        |
| 3 | Green room C   | 11 | Auditorium foyer       |
| 4 | Green room D   | 12 | Atrium                 |
| 5 | Green room E   | 13 | Main hall foyer        |
| 6 | Green room F   | 14 | Outdoor plaza          |
| 7 | Meeting room 7 | 15 | Loading bay            |
| 8 | Office         | 16 | Changing places toilet |

- |   |                      |
|---|----------------------|
| ♿ | Toilets              |
| ☕ | Coffee shop          |
| ⬆ | Lift                 |
| 🪜 | Stairs               |
| 🪜 | Escalator            |
| 💧 | Water refill station |



# FIRST FLOOR

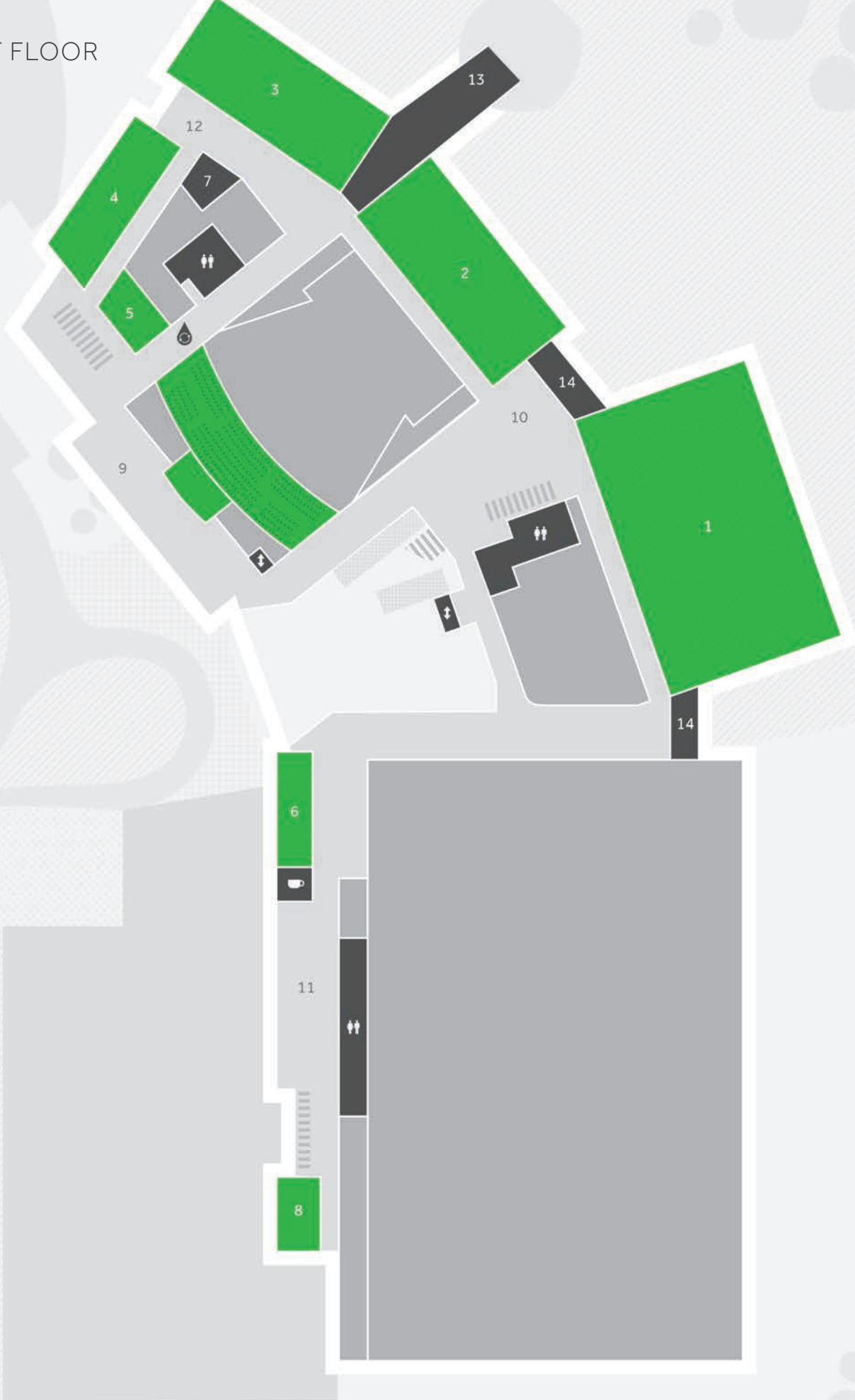

- |                  |                          |                        |
|------------------|--------------------------|------------------------|
| 1 Meeting room 1 | 8 Executive boardroom    | ☺ Toilets              |
| 2 Meeting room 2 | 9 Aspect bar             | ☕ Coffee shop          |
| 3 Meeting room 3 | 10 Woodland suite foyer  | ⬆ Lift                 |
| 4 Meeting room 4 | 11 Plaza view foyer      | ⬆ Stairs               |
| 5 Meeting room 5 | 12 Meeting room breakout | ⬆ Escalator            |
| 6 Meeting room 6 | 13 Woodland access       | 💧 Water refill station |
| 7 Client office  | 14 Outdoor terrace       |                        |

SECOND FLOOR

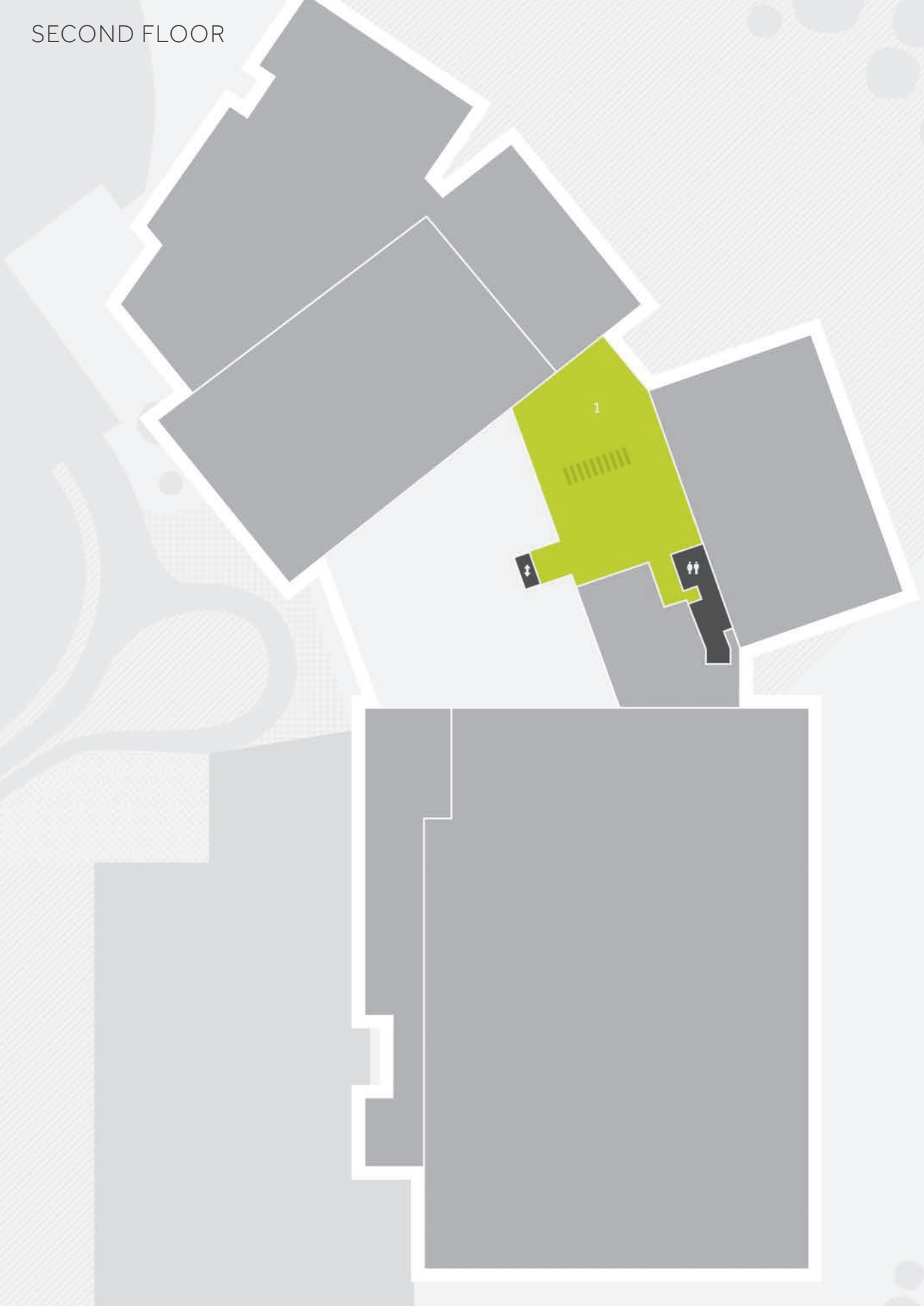

- 1 The Lounge
- ♣♣ Toilets
- ⬇ Lift
- ||| Stairs

FLOOR -1

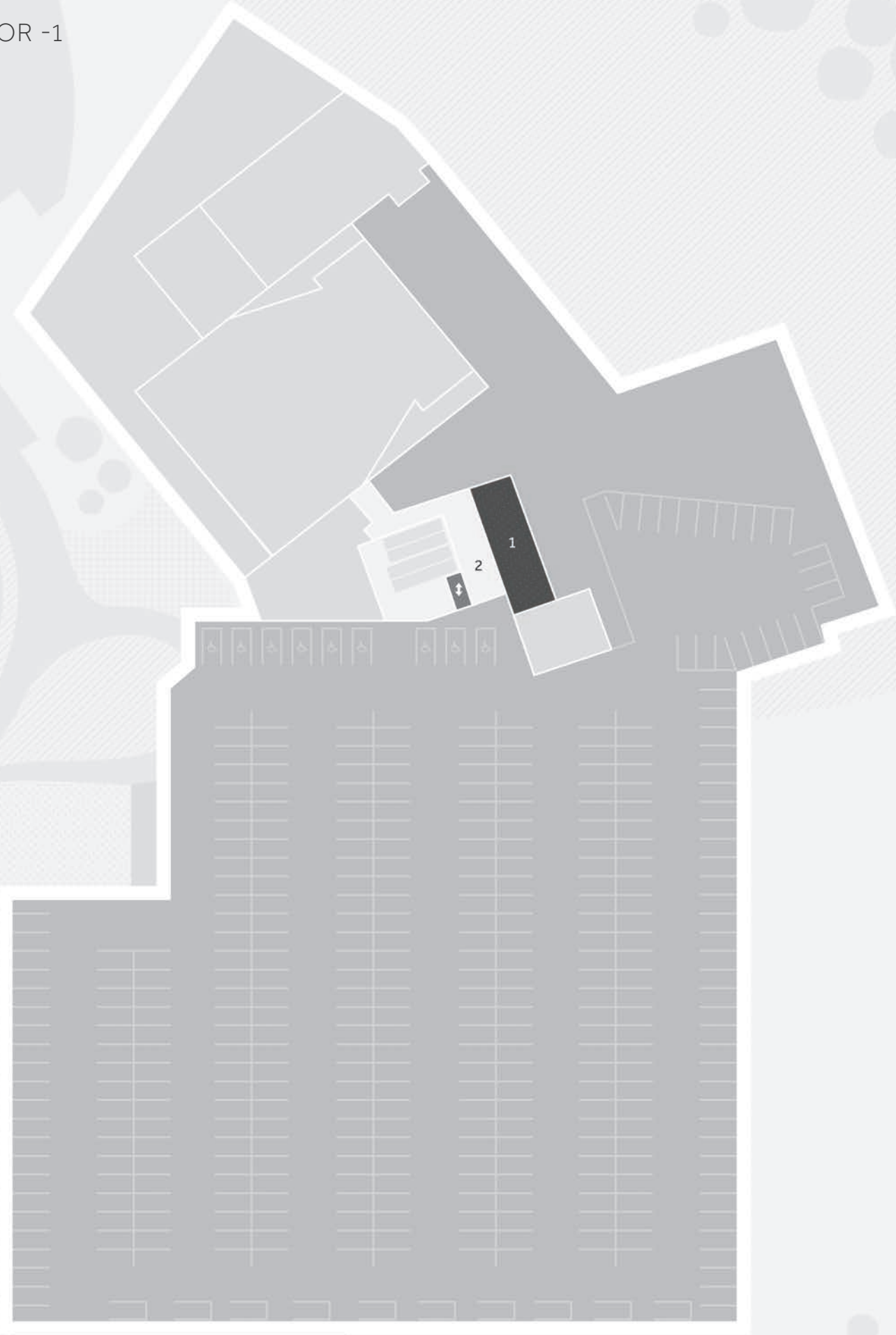

- 1 Cloakroom
- 2 Access from underground parking
- ⇕ Lift
- Escalator

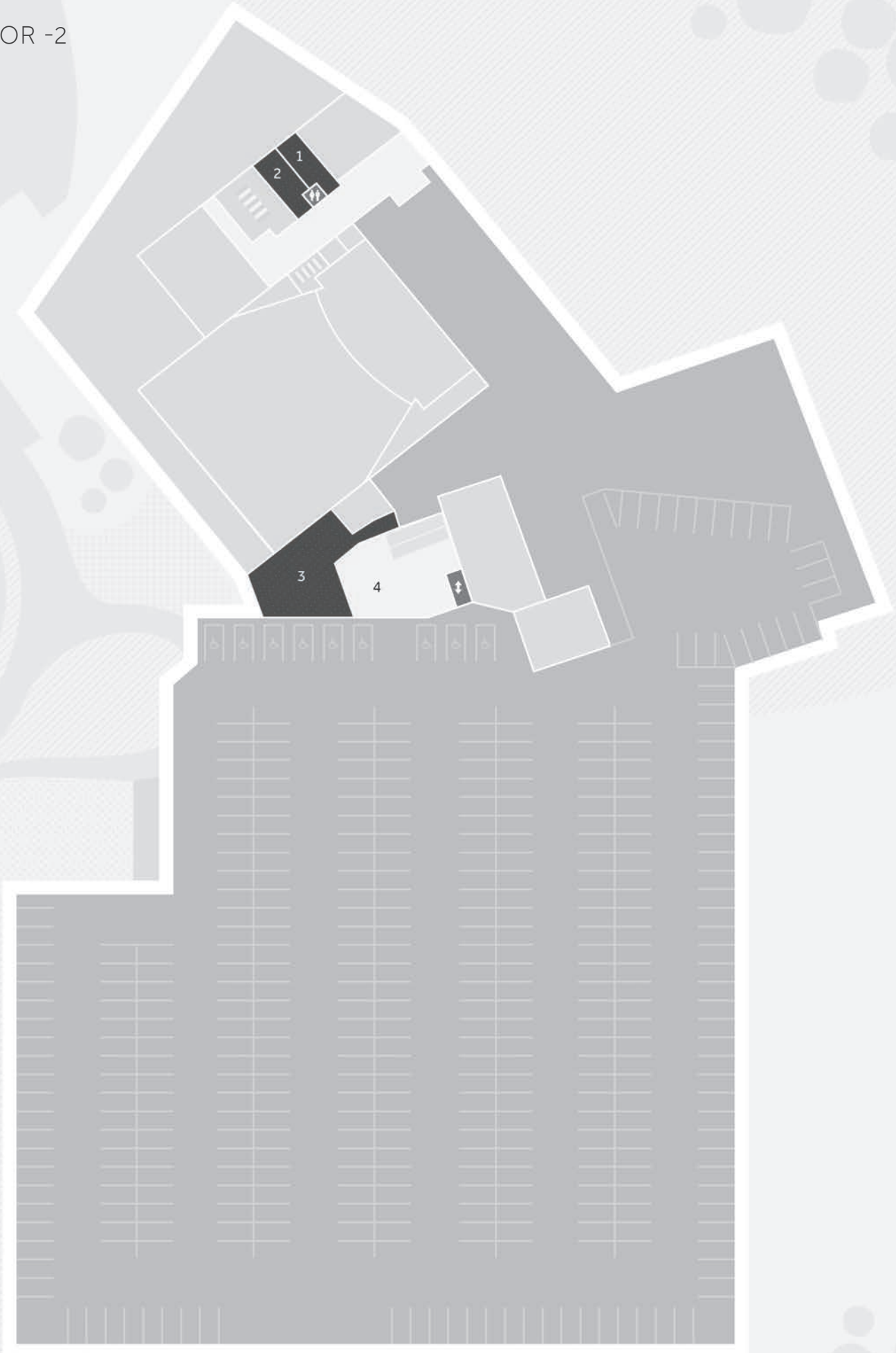

- 1 Green room A
- 2 Green room B
- 3 Bag drop / luggage store
- 4 Access from underground parking

- ♠♠ Toilets
- ⬆ Lift
- ≡ Stairs
- ≡ Escalator



ROOM	LEVEL ACCESS	DIVISIBLE SECTIONS	DIMENSIONS (m)	SIZE (square metre)	THEATRE	CARBARET tables of 8 with standard stage only	BANQUET tables of 10 with small stage
Main hall	Ground	All	80 x 50	4000	4100	2464	3080
		A (1/3)	32 x 50	1600	1650	896	1120
		B (1/3)	24 x 50	1200	1235	784	980
		C (1/3)	24 x 50	1200	1235	784	980
		D (2/3)	56 x 50	2800	2855	1680	2100
		E (2/3)	48 x 50	2400	2475	1456	1960
		F (1/2)	40 x 50	2000	2050	1232	1540
		G (1/2)	40 x 50	2000	2050	1232	1540
		H (1/4)	25 x 40	1000	1030	616	770
		I (1/4)	25 x 40	1000	1030	616	770
		J (1/4)	25 x 40	1000	1030	616	770
		K (1/4)	25 x 40	1000	1030	616	770
		L	32 x 25	800	825	448	560
		M	32 x 25	800	825	448	560
		N	24 x 33	792	820	432	540
		O	24 x 17	408	420	192	240
		P	24 x 25	600	620	336	420
		Q	24 x 25	600	620	336	420
		R (half 2/3)	48 x 25	1200	1235	784	980
		S (half 2/3)	48 x 25	1200	1235	784	980
		T (half 2/3)	56 x 25	1400	1440	840	1050
		U (half 2/3)	56 x 25	1400	1440	840	1050
		V (1/2 lengthways)	80 x 25	2000	2050	1232	1540
W (1/2 lengthways)	80 x 25	2000	2050	1232	1540		
X	24 x 25	600	620	336	420		
Y	24 x 25	600	620	336	420		
Auditorium	Ground & First	All			1500	n/a	n/a
		Upper			762	n/a	n/a
		Lower			738	n/a	n/a
ROOM	LEVEL ACCESS	DIVISIBLE SECTIONS	DIMENSIONS (m)	SIZE (square metre)	THEATRE	CARBARET tables of 8 with standard stage only	BANQUET tables of 10 without stage or dance floor
Meeting Room 1 (Woodland suite)	First	All	38 x 23	875	900	432	660
		1A	12.5 x 23	287	300	112	170
		1B	12.5 x 23	287	300	112	170
		1C	12.5 x 23	287	300	112	170
		1D	19 x 23	437	450	184	280
		1E	19 x 23	437	450	184	280
		1F	25 x 23	575	600	304	390
		1G	25 x 23	575	600	304	390
Meeting room 2	First	All	29 x 12.5	362.5	370	192	260
		2A	9.5 x 12.5	112.5	110	56	70
		2B	9.5 x 12.5	112.5	600	62	70
		2C	9.5 x 12.5	112.5	600	56	70
		2D	14 x 12.5	175	180	96	120
		2E	14 x 12.5	175	180	96	120
		2F	20 x 12.5	250	260	120	150
		2G	20 x 12.5	250	260	120	150
Meeting room 3	First	All	28 x 12	336	340	192	260
		3A	9 x 12	108	100	48	60
		3B	9 x 12	108	100	48	60
		3C	9 x 12	108	100	48	60
		3D	14 x 12	170	160	96	120
		3E	14 x 12	170	160	96	120
		3F	19 x 12	240	240	120	150
		3G	19 x 12	240	240	120	150
Meeting room 4	First	All	20 x 7.5	153.5	150	80	100
		4A	10.5 x 7.5	78.5	65	40	n/a
		4B	9.5 x 7.5	71	65	40	n/a
Meeting room 5	First		8 x 6	53	30 (boardroom 21)	n/a	n/a
Meeting room 6 en suite			11 x 4.5	56.8	30 (boardroom 27)	n/a	n/a
Meeting room 7			8.25 x 8	66	45 (boardroom 21)	n/a	n/a
Executive boardroom			9 x 5.5	51.4	boardroom 20	n/a	n/a

	ROOM	LEVEL ACCESS	DIVISIBLE SECTIONS	DIMENSIONS (m)	SIZE (square metre)	THEATRE	CARBARET tables of 8 with standard stage only	BANQUET tables of 10 without stage or dance floor
ADDITIONAL SPACES	Office	Ground		8.5 x 3	25.5	n/a	n/a	n/a
	Office	First		5 x 3	22.1	n/a	n/a	n/a
	Business centre	Ground		6.5 x 7.5	43.5	n/a	n/a	n/a
	Green room A en suite	-2		2.75 x 7.5	20.7	n/a	n/a	n/a
	Green room B en suite	-2		2.75 x 7.5	20.7	n/a	n/a	n/a
	Green room C / office en suite	Ground		5 x 8	36.7	n/a	n/a	n/a
	Green room D / office	Ground		4.5 x 6.5	30.2	n/a	n/a	n/a
	Green room E / office en suite	Ground		4.5 x 6.5	30.2	n/a	n/a	n/a
	Green room F / office en suite	Ground		4.5 x 6.5	30.2	n/a	n/a	n/a
NETWORKING SPACES	Atrium	Ground			800			
	Auditorium foyer	Ground			200			
	Main hall foyer	Ground			400			
	Outdoor plaza	Ground			2,500			
	Aspect bar	First			210			
	Meeting room breakout	First			200			
	Meeting room 1 foyer	First			450			
	Plaza view foyer	First			360			
	The lounge	Second			500			