

# ARE YOU BUILT TO LEAD?

International Convention Centre Wales

[iccwales.com](http://iccwales.com)

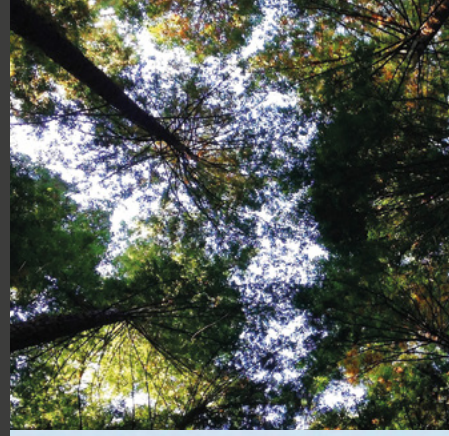





# SURROUNDED BY FRESH AIR & WOODLAND, YET A STONE'S THROW FROM THE M4.

International Convention Centre Wales.  
Beautifully built. Conveniently located.

We travelled the globe, uncovering what  
makes the world's most inspiring convention  
centres. The result is the internationally  
outstanding ICC Wales. Bridging the gap  
between the grey and the green, the  
industry and the environment.

Built within stunning woodland, yet a stone's  
throw from the M4, ICC Wales' unexpected  
angles and strong lines emerge with confidence,  
boldly asserting its presence above the M4 as Wales  
announces its convention centre to the world.

ICC Wales, leading the way. Let's go.





# AN INSIGHT DRIVEN BUILDING

ICC WALES IN A NUTSHELL

Dedicated exhibitor parking, tick.  
Meeting rooms and breakout rooms, tick.  
Fabulous food created, cooked and served on site,  
tick. HGV loading and parking, tick.

We've even taken on some seriously big requests.  
A 4,000 sqm pillar free main hall and 700 car parking  
spaces. All this and a stone's throw from the M4,  
major train stations and 2 international airports.  
With a proven track record of hosting the 2010  
Ryder Cup and 2014 NATO Summit, we know  
how to run and implement events with passion,  
care and distinction.

We look forward to opening our doors and giving  
a big warm welcome to the global conference  
and association market.

- Key features:**
- + Auditorium with tiered seating for 1,500 with 762 on the upper level and 738 on lower level
  - + 4,000 sqm pillar free space, flexible and divisible into 6 sections
  - + 15 flexible meeting rooms
  - + 26,000 sqm of total floor space
  - + Up to 5,000 delegates at one time
  - + Generous atrium entrance with 2,500 sqm outdoor plaza
  - + Natural daylight in all meeting rooms and the main hall
  - + Networking spaces on all levels
  - + Dedicated facilities for clients and production teams
  - + Direct loading for production and exhibition vehicles



“We  
designed  
with the  
client in  
mind, 100%  
of the time”

Russell Phillips  
Vice President of Facilities  
ICC Wales





“NATO was a huge learning curve and gave us insights into the design and build that we’re really excited about sharing”

Nancy Mollett  
Convention Centre Director, ICC Wales



## 1,500 seat auditorium

At the heart of ICC Wales is a state of the art auditorium. A dynamic and inspiring space with tiered seating for 1,500 with 762 on the upper level and 738 on lower level. Overlooking the atrium, the aspect bar offers 210 sqm of networking space, flooded by natural light.

## Convention Countdown

**100%**  
free wifi  
100% of the time

**24/7**  
IT & technical  
support

**4** legs to  
lean on  
Purpose built  
registration desks

**3 courses**  
& more  
Dedicated in house  
catering facilities

**Dedicated** Event Manager  
From start to finish

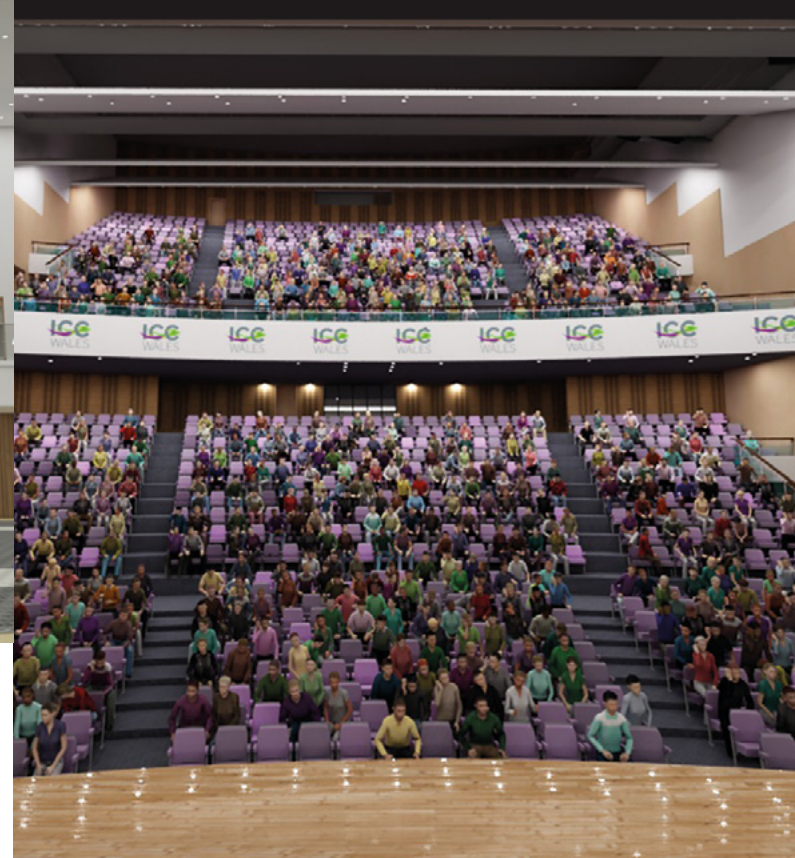

## Up to 5,000 delegates at one time

The Celtic Manor Resort proudly hosted the Ryder Cup 2010, 2014 NATO Summit, and several hundred successful conferences, resulting in us being voted No 1 Conference Hotel for five years running. It left us in a position where we had to turn away business because we didn't have capacity to satisfy certain events.

Turning away business is not something I am in the habit of doing! It makes me very happy indeed to be working with Welsh Government and the ICC Wales team to deliver the International Convention Centre Wales.

We sincerely hope you enjoy.

*Terry M*

Sir Terry Matthews

“We travelled the world, taking inspiration from outstanding convention centres, to create one building that had the best of everything”

Jill Manley  
Business Development Director  
ICC Wales



## Networking spaces

Take a breath of fresh air and discover a stunning venue surrounded by woodland.

- + Versatile breakout areas from the main hall, auditorium and syndicate rooms
- + Bridge access from Level 1 to the woodland
- + Spacious atrium and lobby spaces
- + Outdoor terraces on all levels
- + A welcoming and generous atrium entrance with 2,500 sqm outdoor plaza



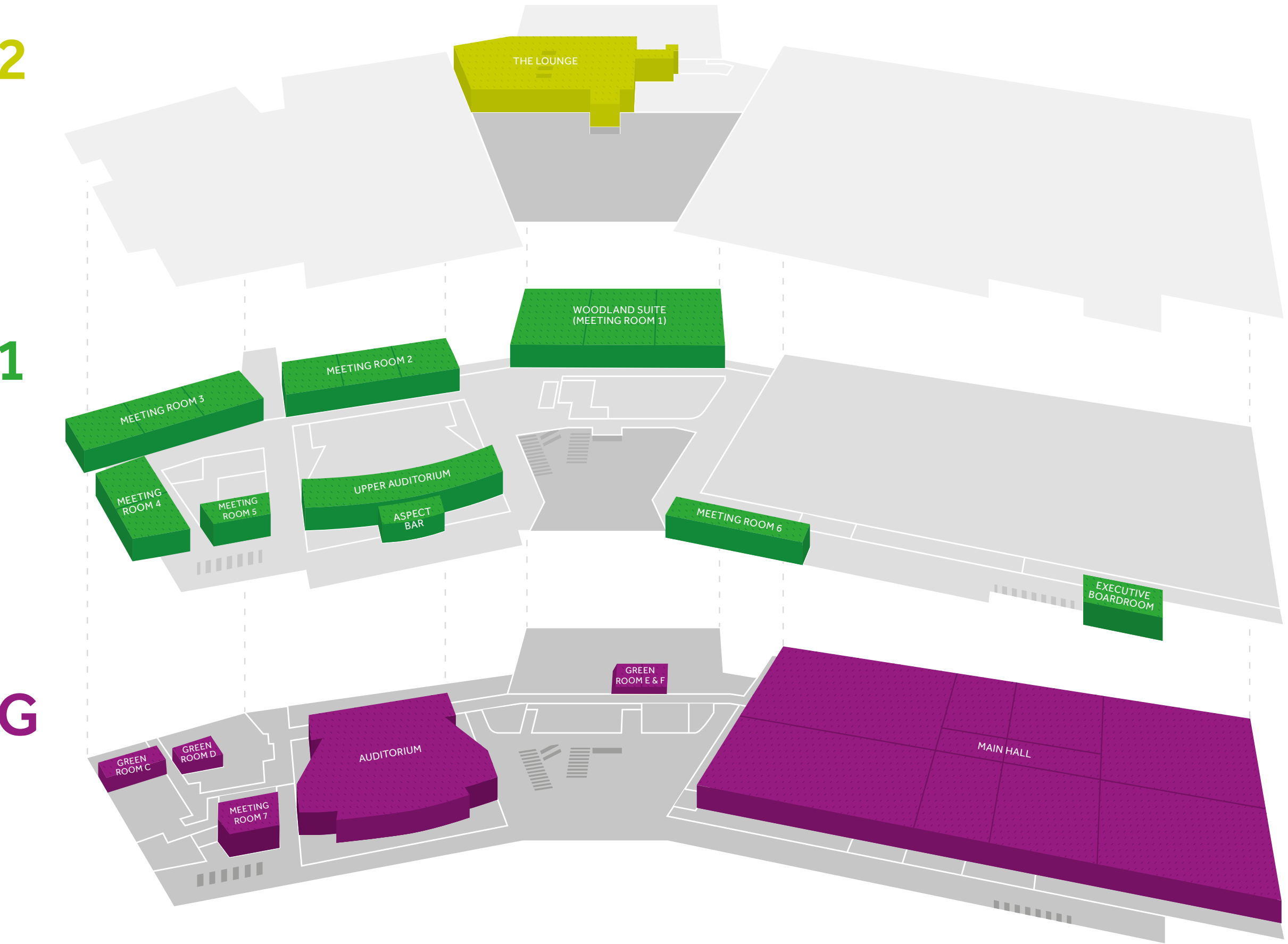

**2** The Lounge  
Toilets  
Lift & stairs

**1** Meeting rooms 1-6  
Upper auditorium  
Executive boardroom  
Cloakroom  
Aspect bar  
Plaza view foyer  
Office  
Meeting room breakout  
Woodland access  
Outdoor terrace  
Toilets  
Coffee shop  
Lift, stairs & escalator  
Water refill station

**G** Auditorium  
Main hall  
Atrium  
Meeting room 7  
Medical room  
Green rooms C, D, E & F  
Business Centre  
Office  
Outdoor plaza  
Toilets  
Changing places toilet  
Coffee shop  
Lift, stairs & escalator  
Water refill stations

**-1** Parking  
Cloakroom  
Lift, stairs & escalator

**-2** Parking  
Green rooms A & B  
Bag drop / luggage store  
Lift, stairs & escalator  
Toilets



# GROUND FLOOR

Welcome to a 'wow' space. Designed to host large events with the flexibility to make them entirely bespoke.

- + Main auditorium with fixed seating for 1,500 delegates
- + Exhibition hall providing flexible and divisible space into 6 rooms
- + 4,000 sqm pillar free space and space for 2,400 guests for a gala dinner
- + Green rooms, production offices and a business centre
- + Coffee shop

ROOM	DIVISIBLE SECTIONS	DIMENSIONS (m)	SIZE (square metres)	THEATRE	CABARET tables of 8 with standard stage only	BANQUET tables of 10 with small stage
Main hall	All	80 x 50	4000	4100	2440	3080
	A (1/3)	32 x 50	1600	1650	896	1120
	B (1/3)	24 x 50	1200	1235	712	890
	C (1/3)	24 x 50	1200	1235	712	890
	D (2/3)	56 x 50	2800	2855	1568	1960
	E (2/3)	48 x 50	2400	2475	1432	1790
	F (1/2)	40 x 50	2000	2050	1120	1540
	G (1/2)	40 x 50	2000	2050	1120	1540
	H (1/4)	25 x 40	1000	1030	544	680
	I (1/4)	25 x 40	1000	1030	544	680
	J (1/4)	25 x 40	1000	1030	544	680
	K (1/4)	25 x 40	1000	1030	544	680
	L	32 x 25	800	825	432	540
	M	32 x 25	800	825	432	540
	N	24 x 33	792	820	432	540
	O	24 x 17	408	420	232	290
	P	24 x 25	600	620	320	400
	Q	24 x 25	600	620	320	400
	R (half 2/3)	48 x 25	1200	1235	712	890
	S (half 2/3)	48 x 25	1200	1235	712	890
	T (half 2/3)	56 x 25	1400	1440	824	1030
	U (half 2/3)	56 x 25	1400	1440	824	1030
	V (1/2 lengthways)	80 x 25	2000	2050	1072	1340
	W (1/2 lengthways)	80 x 25	2000	2050	1072	1340
	X	24 x 25	600	620	320	400
	Y	24 x 25	600	620	320	400
Auditorium	All			1500	n/a	n/a
	Upper			762	n/a	n/a
	Lower			738	n/a	n/a
Meeting room 7		8.25 x 8	66	45 (boardroom 21)	n/a	n/a
Office		9 x 2	18	n/a	n/a	n/a
Business centre		6.5 x 7.5	43.5	n/a	n/a	n/a

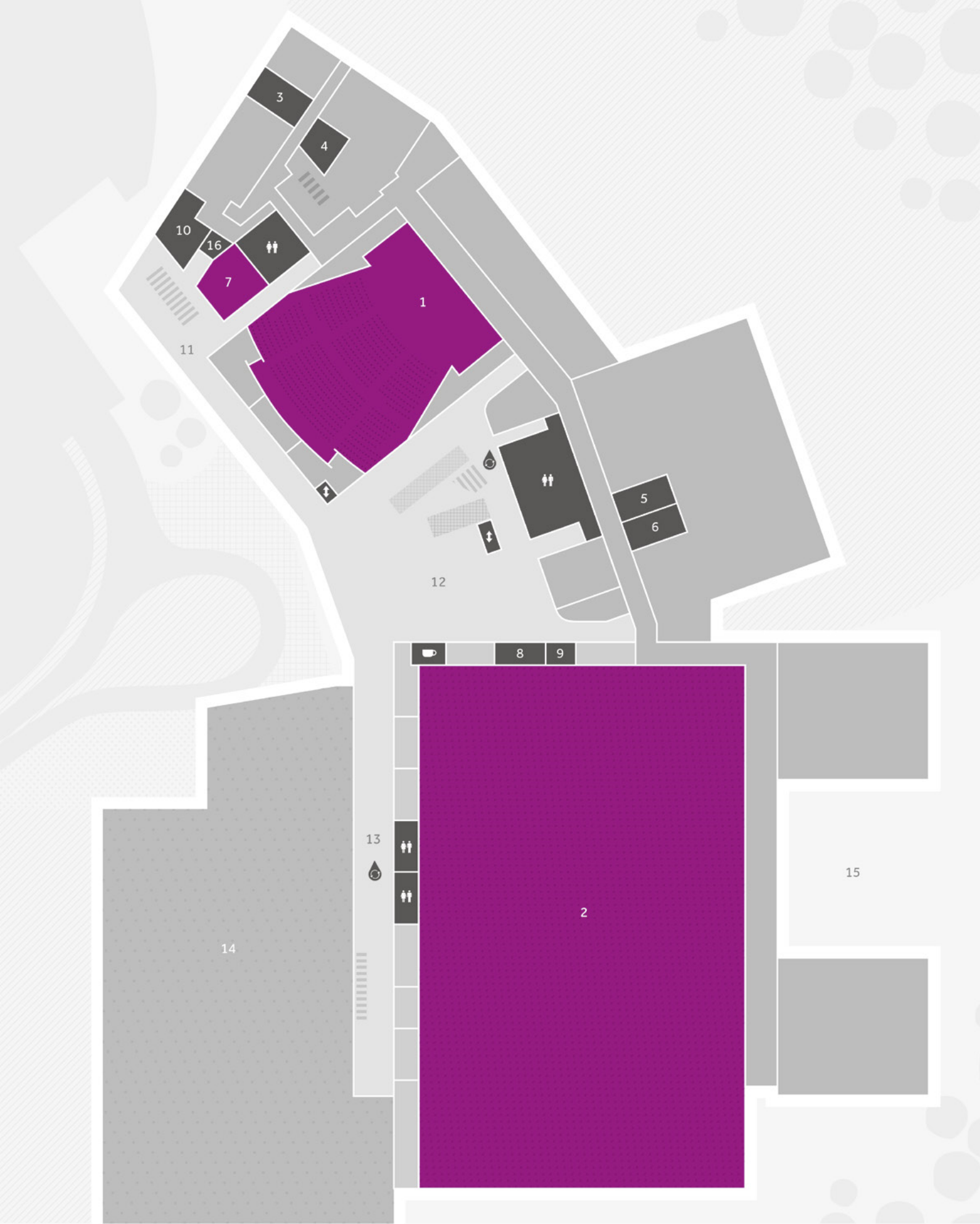

- 1

Auditorium
- 2

Main hall
- 3

Green room C
- 4

Green room D
- 5

Green room E
- 6

Green room F
- 7

Meeting room 7
- 8

Office
- 9

Medical room
- 10

Business centre
- 11

Auditorium foyer
- 12

Atrium
- 13

Main hall foyer
- 14

Outdoor plaza
- 15

Loading bay
- 16

Changing places toilet

- ♂ ♀

Toilets
- ☕

Coffee shop
- ⬆

Lift
- 🚪

Stairs
- 🚶

Escalator
- 💧

Water refill station



# MAIN HALL

GROUND FLOOR

A **4,000** sqm carpeted pillar free space

A purpose built exhibition hall with 4,000 sqm of pillar free space. Providing direct loading and dedicated parking for production and exhibition vehicles. Leading the way for your event.

- + 4,000 sqm of pillar free space
- + Flexible and divisible into 6 sections
- + Green rooms and production office
- + 2 points of entry for direct vehicle access
- + Floor trunking throughout
- + Fully carpeted space
- + 9 metre ceiling height



\* capacities are shown in theatre style seating



# THE AUDITORIUM

GROUND FLOOR

1,500   
seat auditorium

The auditorium is state of the art and a dynamic inspiring space, with fixed theatre style seating for 1,500 delegates.

- + Tiered seating for 1,500 with 762 on the upper level and 738 on lower level
- + 210 sqm Aspect Bar with floor to ceiling windows
- + Dedicated production access and loading to stage level
- + Production storage area
- + Green rooms
- + Access for delegates on ground and first floor
- + Production packages available
- + 11.5m stage depth
- + Plug sockets, USB charging points and writing desks at each seat

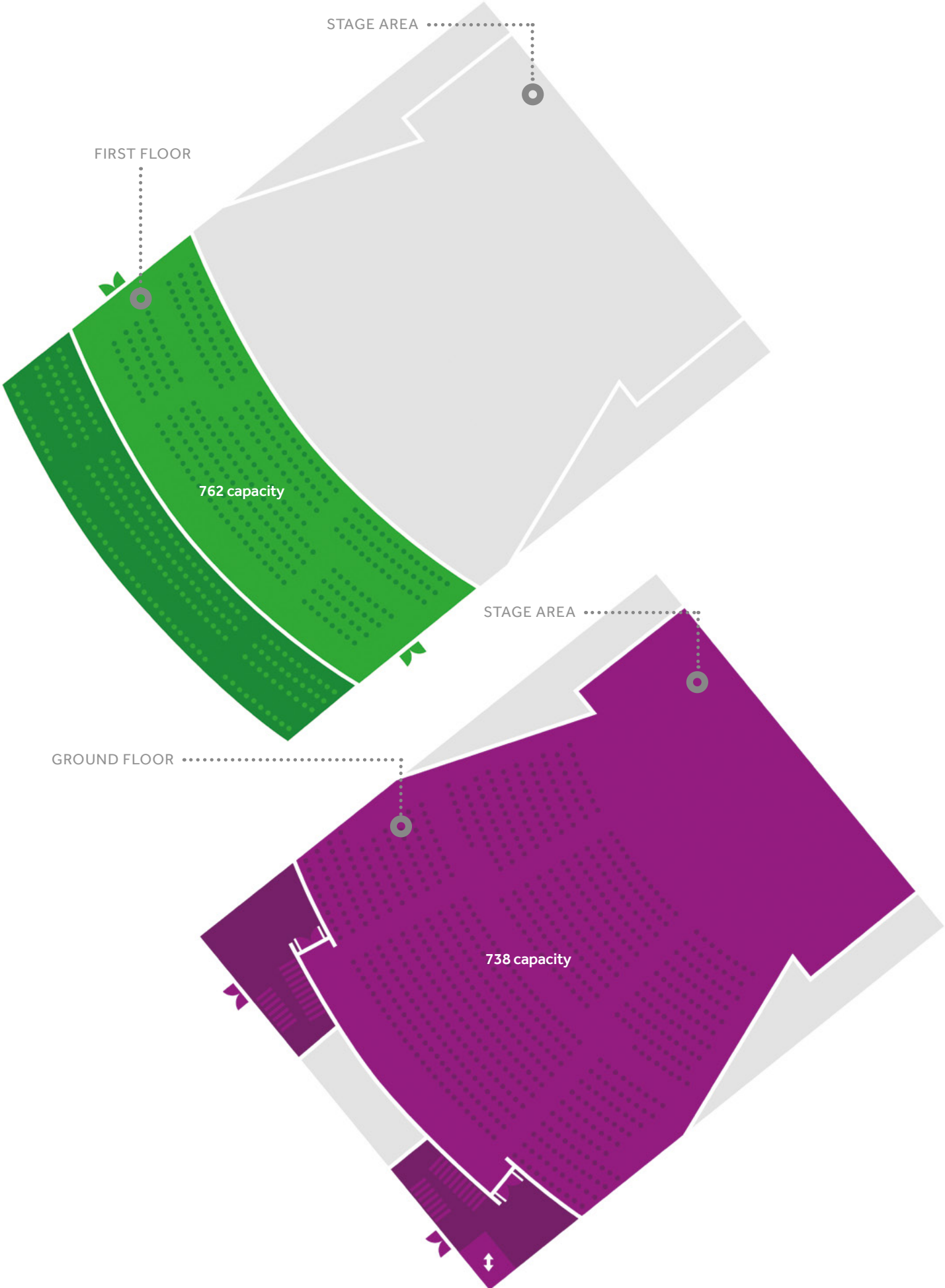



# ATRIUM

## GROUND FLOOR

A bright and airy space surrounded by glass, greenery and warm welcomes. Meet, greet, check in and chill. We'll have it covered.

- + Integrated ceiling truss suitable for branding display
- + Oversized LED display wall
- + Flexible event space with ample AV / IT integration
- + Space for Registrations



# PLAZA

## ACCESS FROM GROUND FLOOR

The gorgeously spacious outdoor plaza is suitable for outside exhibitions, fresher networking and breakouts. Flexible landscaping that can be versatile in what it can accommodate. It's perfect for the main event or as an add on.

- + 2,500 sqm
- + Wifi connectivity outside



# FIRST FLOOR

An abundance of meeting rooms that work flexibly. Formal or informal schemes can be set up to deliver an event that exceeds your expectations.

- + 15 flexible meeting rooms
- + Client office
- + Coffee shop

ROOM	CEILING HEIGHT (m)	DIVISIBLE SECTIONS	DIMENSIONS (m)	SIZE (square metres)	THEATRE	CABARET tables of 8 with standard stage only	BANQUET tables of 10 without stage or dance floor
Meeting room 1 (Woodland suite)	5.6m	All	38 x 23	874	900	432	660
		1A	12.5 x 23	287	300	112	170
		1B	12.5 x 23	287	300	112	170
		1C	12.5 x 23	287	300	112	170
		1D	19 x 23	437	450	184	280
		1E	19 x 23	437	450	184	280
		1F	25 x 23	575	600	304	390
		1G	25 x 23	575	600	304	390
Meeting room 2	4m	All	29 x 12.5	362.5	370	192	260
		2A	9.5 x 12.5	112.5	110	56	70
		2B	9.5 x 12.5	112.5	110	62	70
		2C	9.5 x 12.5	112.5	110	56	70
		2D	14 x 12.5	175	180	96	120
		2E	14 x 12.5	175	180	96	120
		2F	20 x 12.5	250	260	120	150
		2G	20 x 12.5	250	260	120	150
Meeting room 3	4m	All	28 x 12	336	340	192	260
		3A	9 x 12	108	100	48	60
		3B	9 x 12	108	100	48	60
		3C	9 x 12	108	100	48	60
		3D	14 x 12	170	160	96	120
		3E	14 x 12	170	160	96	120
		3F	19 x 12	240	240	120	150
		3G	19 x 12	240	240	120	150
Meeting room 4	4m	All	20 x 7.5	153.5	150	80	100
		4A	10.5 x 7.5	78.5	65	40	n/a
		4B	9.5 x 7.5	71	65	40	n/a
Meeting room 5	3m		8 x 6	53	30 (boardroom 21)	n/a	n/a
Meeting room 6 en suite			11 x 4.5	56.8	30 (boardroom 27)	n/a	n/a
Executive boardroom	3m		9 x 5.5	51.4	boardroom 20	n/a	n/a
Office			5 x 3	22.1	6	n/a	n/a

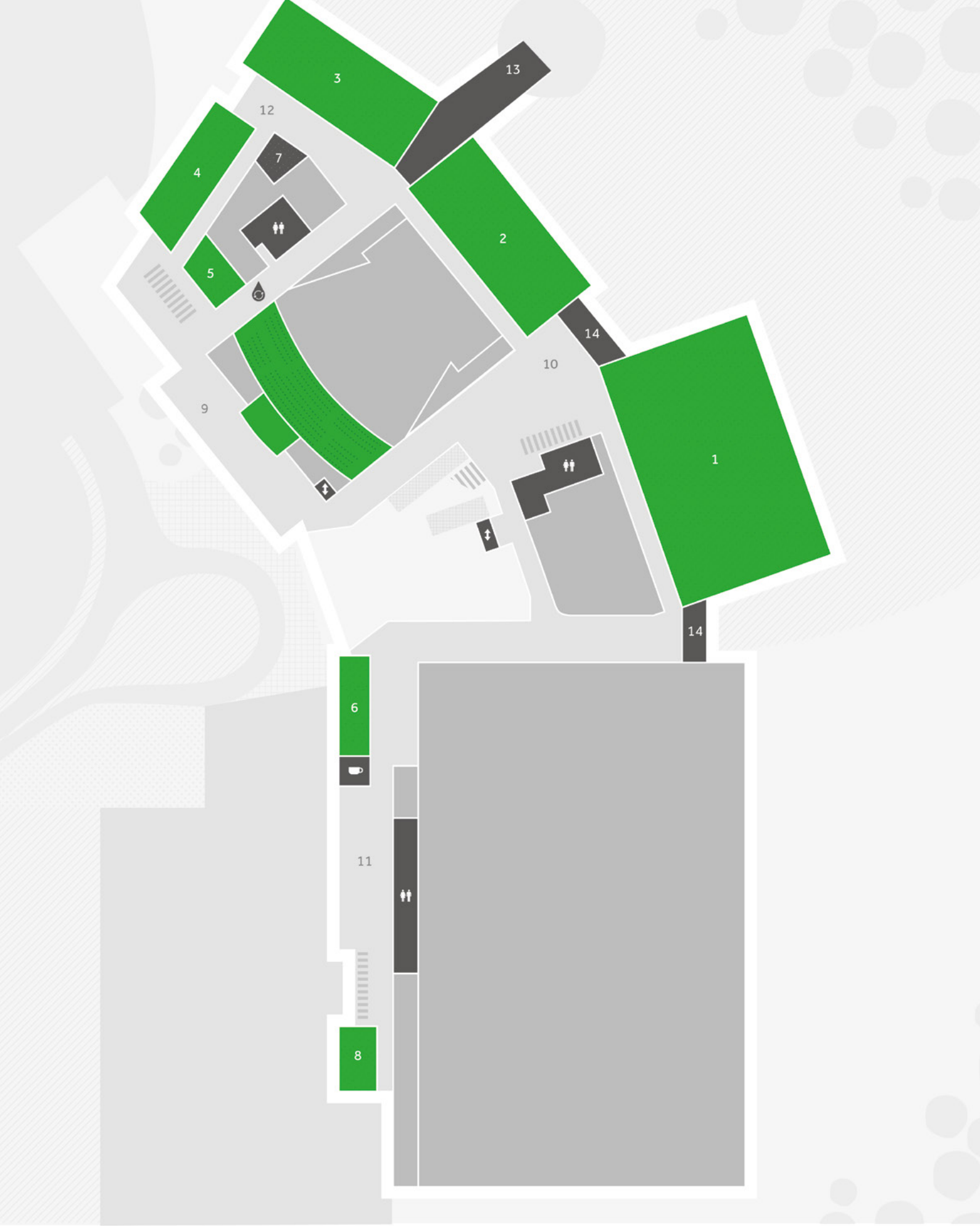

- 1 Meeting room 1

2 Meeting room 2

3 Meeting room 3

4 Meeting room 4

5 Meeting room 5

6 Meeting room 6

7 Client office
- 8 Executive boardroom

9 Aspect bar

10 Woodland suite foyer

11 Plaza view foyer

12 Meeting room breakout

13 Woodland access

14 Outdoor terrace
- Toilets

Coffee shop

Lift

Stairs

Escalator

Water refill station



# MEETING ROOMS

FIRST FLOOR

- + 15 flexible meeting rooms
- + Capacity for 660 diners in the largest room (900 sqm)
- + Capacity for 1,790 theatre style across these rooms
- + Inclusive AV packages available



# EXECUTIVE BOARDROOM

- + Boardroom for 20 persons
- + Bespoke meeting space overlooking the main plaza
- + Intelligent lighting and integrated presentation technology
- + Fresh bean to cup coffee and cold refreshment station
- + Storage area



MEETING ROOM 1  
(WOODLAND SUITE)  
FIRST FLOOR

Bringing fresh air to your events with outdoor terraces adjacent to woodland and a foyer which overlooks the impressive and inspiring atrium. All of this plus outstanding catering from our dedicated on site culinary team, adding those finishing touches to complement your event.

- + 875 sqm of pillar free space
- + 900 theatre style
- + Banqueting for 660
- + Divisible for flexible configurations



ROOM	CEILING HEIGHT (m)	DIVISIBLE SECTIONS	DIMENSIONS (m)	SIZE (square metres)	THEATRE	CABARET tables of 8 with standard stage only	BANQUET tables of 10 without stage or dance floor
Meeting room 1 (Woodland suite)	5.6m	All	38 x 23	874	900	432	660
		1A	12.5 x 23	287	300	112	170
		1B	12.5 x 23	287	300	112	170
		1C	12.5 x 23	287	300	112	170
		1D	19 x 23	437	450	184	280
		1E	19 x 23	437	450	184	280
		1F	25 x 23	575	600	304	390
		1G	25 x 23	575	600	304	390

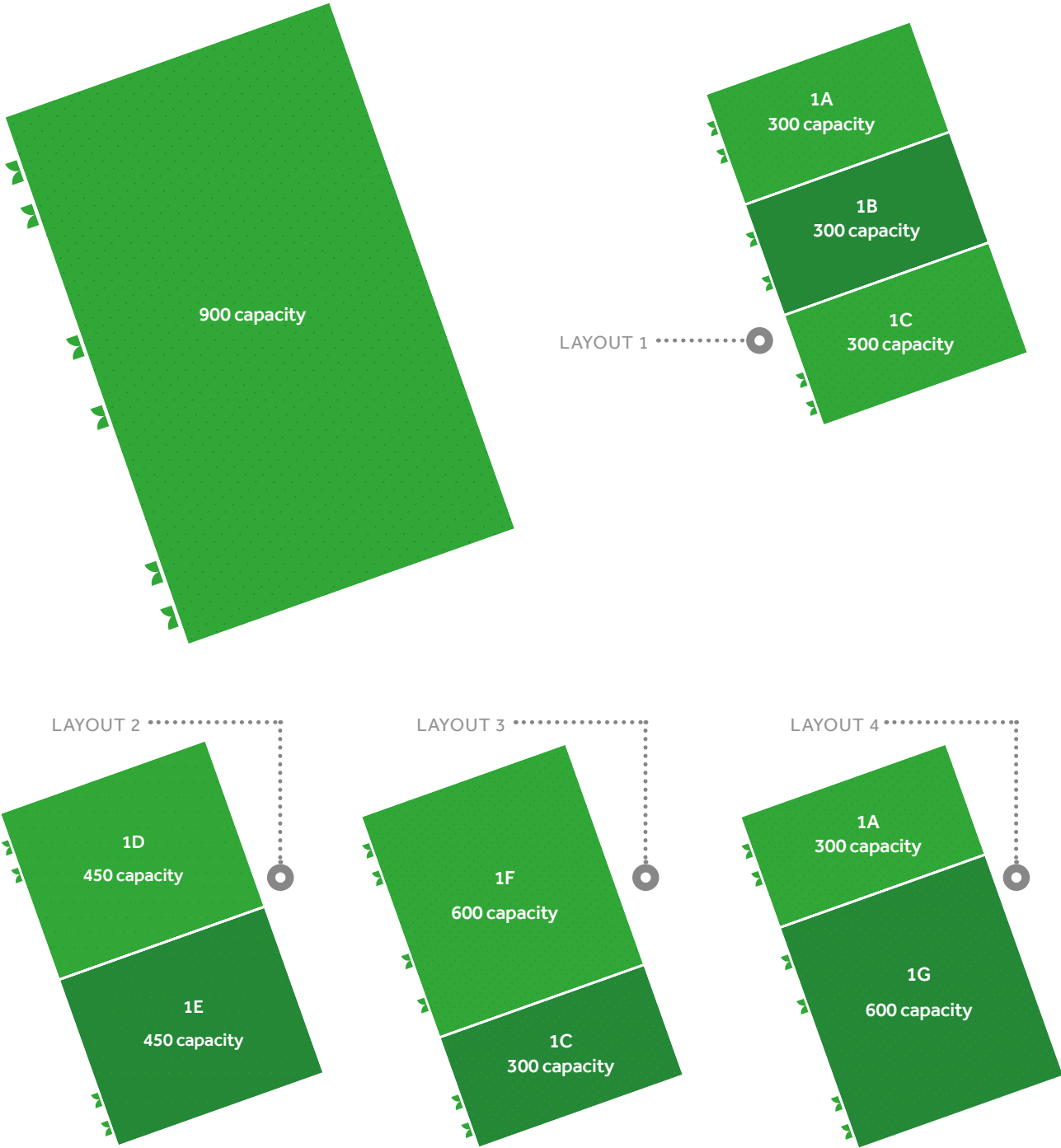

\*theatre style



# MEETING ROOMS 2 - 7

## FLOOR PLAN & CAPACITIES

### MEETING ROOM 2

ROOM	CEILING HEIGHT (m)	DIVISIBLE SECTIONS	DIMENSIONS (m)	SIZE (square metres)	THEATRE	CABARET tables of 8 with standard stage only	BANQUET tables of 10 without stage or dance floor
Meeting room 2	4m	All	29 x 12.5	362.5	370	192	260
		2A	9.5 x 12.5	112.5	110	56	70
		2B	9.5 x 12.5	112.5	110	62	70
		2C	9.5 x 12.5	112.5	110	56	70
		2D	14 x 12.5	175	180	96	120
		2E	14 x 12.5	175	180	96	120
		2F	20 x 12.5	250	260	120	150
		2G	20 x 12.5	250	260	120	150

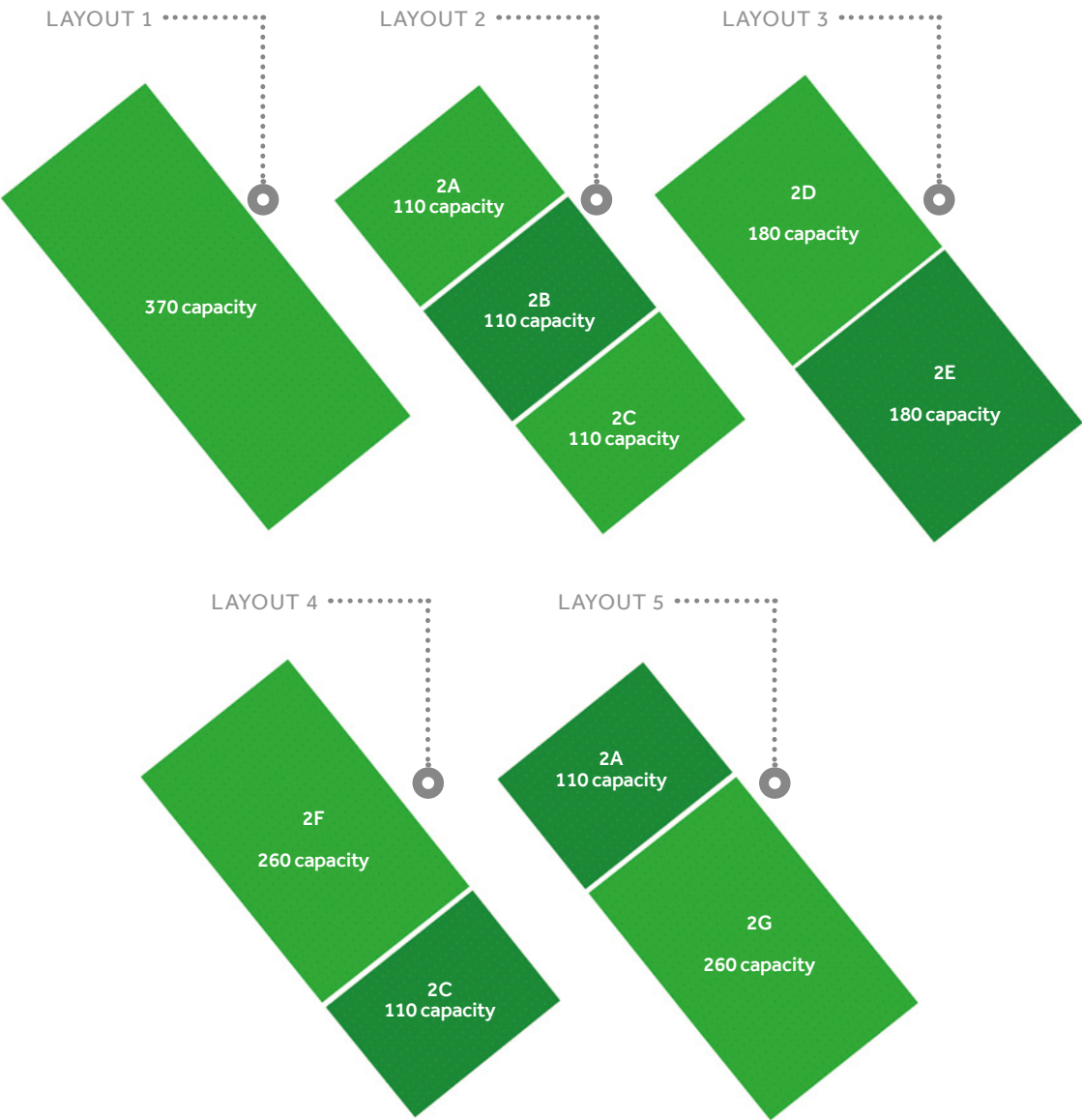

### MEETING ROOM 3

ROOM	CEILING HEIGHT (m)	DIVISIBLE SECTIONS	DIMENSIONS (m)	SIZE (square metres)	THEATRE	CABARET tables of 8 with standard stage only	BANQUET tables of 10 without stage or dance floor
Meeting room 3	4m	All	28 x 12	336	340	192	260
		3A	9 x 12	108	100	48	60
		3B	9 x 12	108	100	48	60
		3C	9 x 12	108	100	48	60
		3D	14 x 12	170	160	96	120
		3E	14 x 12	170	160	96	120
		3F	19 x 12	240	240	120	150
		3G	19 x 12	240	240	120	150

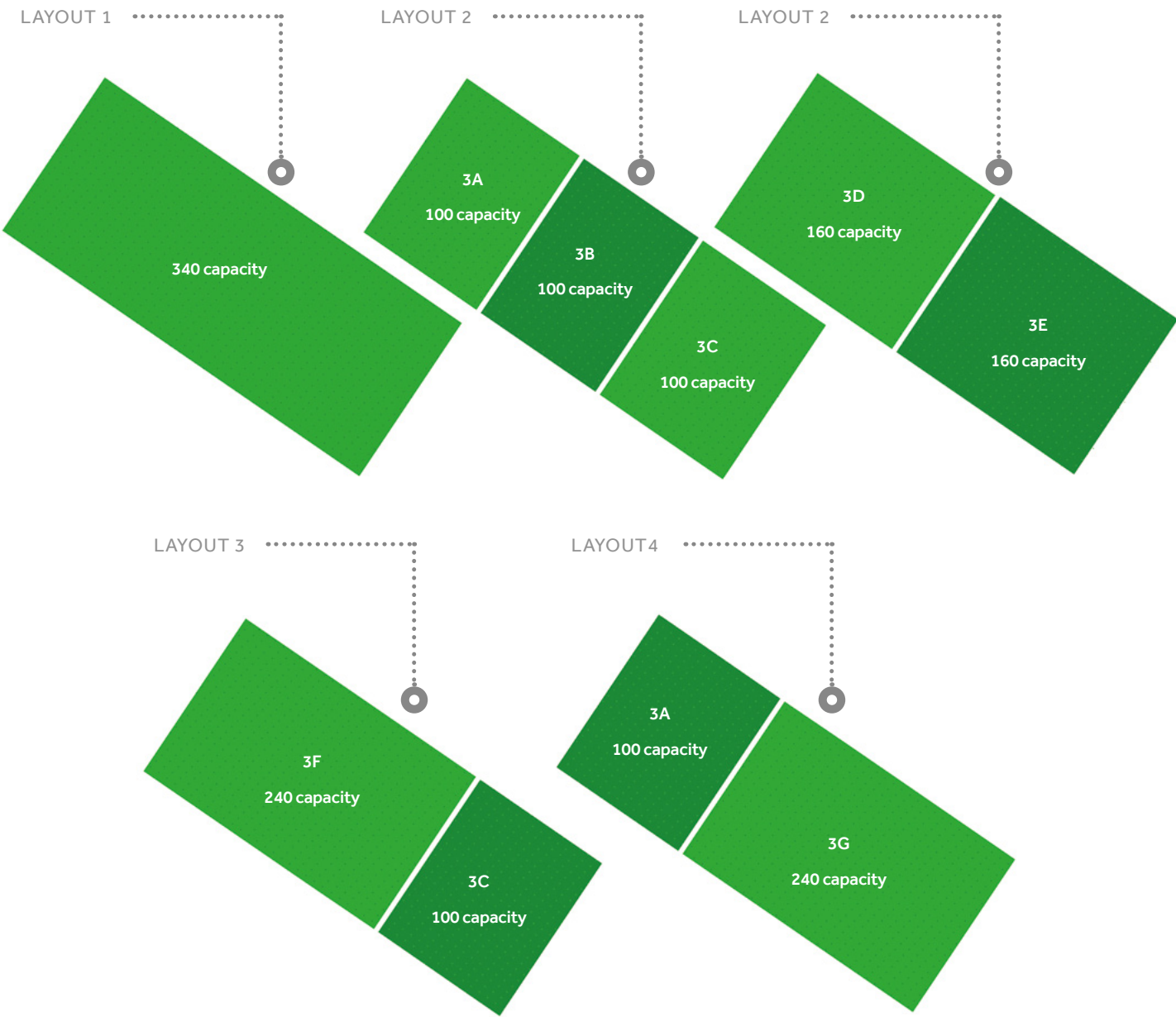



MEETING ROOM 4

ROOM	CEILING HEIGHT (m)	DIVISIBLE SECTIONS	DIMENSIONS (m)	SIZE (square metres)	THEATRE	CABARET tables of 8 with standard stage only	BANQUET tables of 10 without stage or dance floor
Meeting room 4	4m	All	20 x 7.5	153.5	150	80	100
		4A	10.5 x 7.5	78.5	65	40	n/a
		4B	9.5 x 7.5	71	65	40	n/a

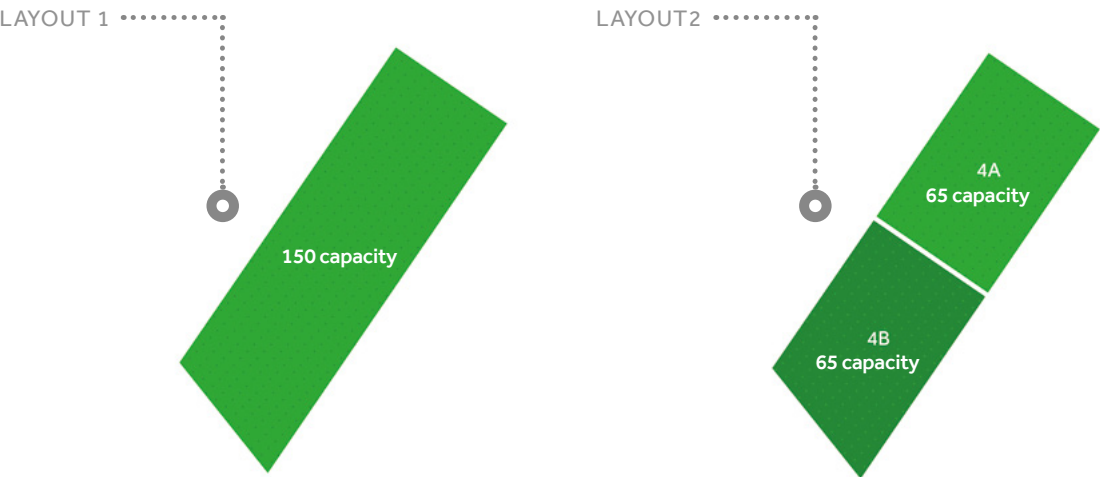

MEETING ROOMS 5, 6 & 7

ROOM	CEILING HEIGHT (m)	DIVISIBLE SECTIONS	DIMENSIONS (m)	SIZE (square metres)	THEATRE	BOARDROOM
Meeting room 5	3m		8 x 6	53	30	21
Meeting room 6 en suite			11 x 4.5	56.8	30	27
Meeting room 7			8.25 x 8	66	45	21



SECOND FLOOR

FLOOR PLAN & CAPACITIES

The Lounge is 500 sqm of space overlooking the impressive main atrium, the perfect space for thinking.

- + Spacious networking area
- + Impressive views over the atrium
- + Suitable for receptions, breakout sessions, exhibitions and catering

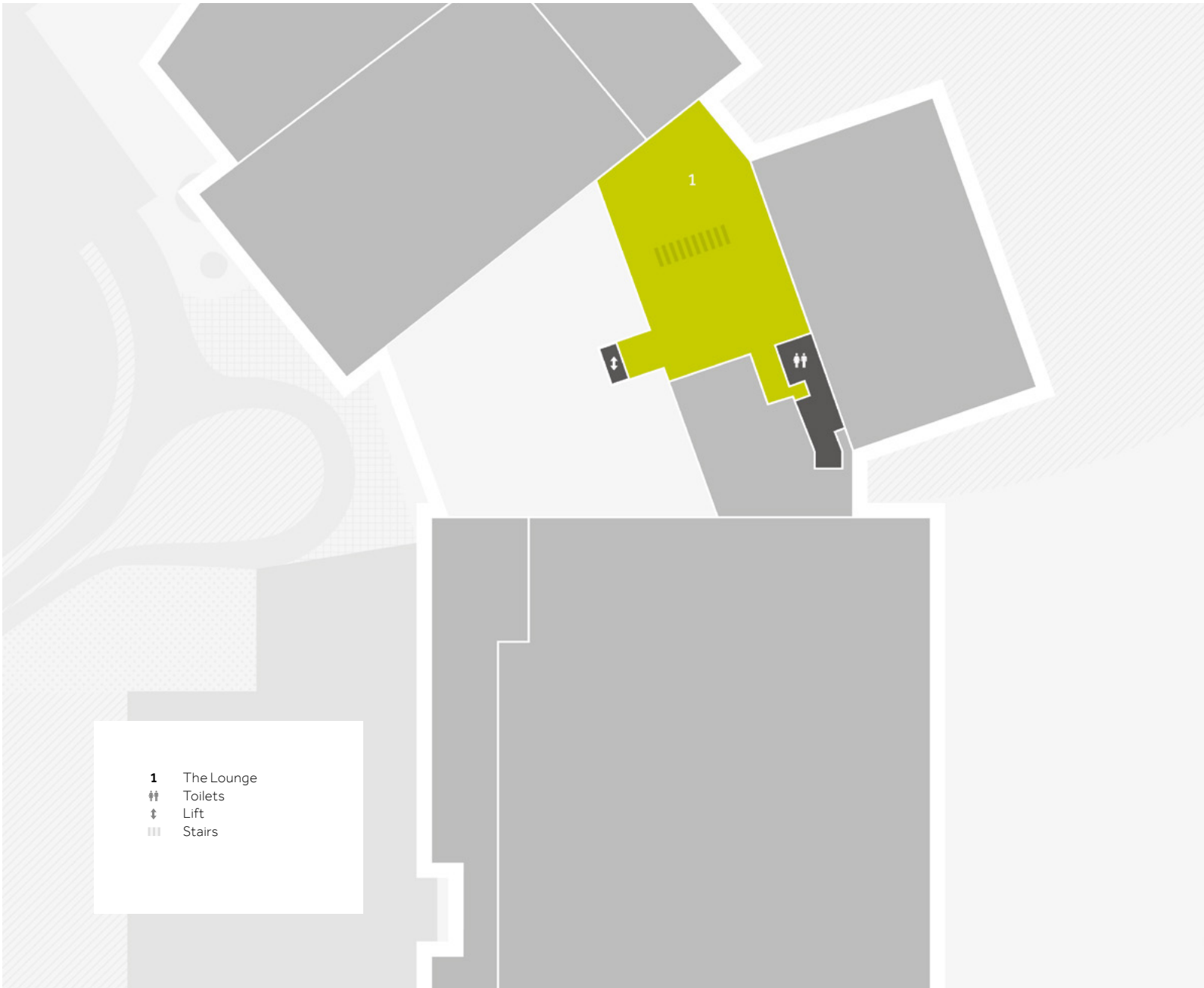



# NETWORKING SPACES

Take a breath of fresh air and discover a stunning venue surrounded by woodland

- + Outdoor areas and adjacent woodland on all levels
- + 2,500 sqm of outdoor plaza space for outdoor exhibitions, networking and breakouts
- + Welcoming and generous plaza entrance
- + Versatile breakout areas from all the central spaces
- + Spacious and impressive atrium and lobby spaces
- + 500 sqm lounge overlooking main atrium, the perfect spot for thinking



## SECOND FLOOR NETWORKING

ROOM	SIZE (square metres)
9. The lounge	500

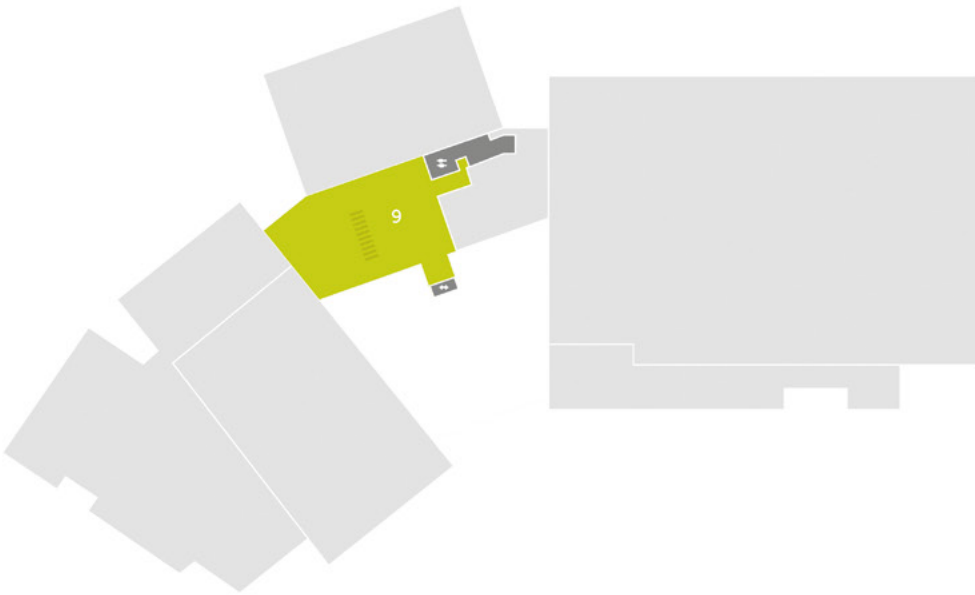

## FIRST FLOOR NETWORKING

ROOM	SIZE (square metres)
5. Aspect bar	210
6. Meeting room breakout	200
7. Meeting room 1 foyer	450
8. Plaza view foyer	360

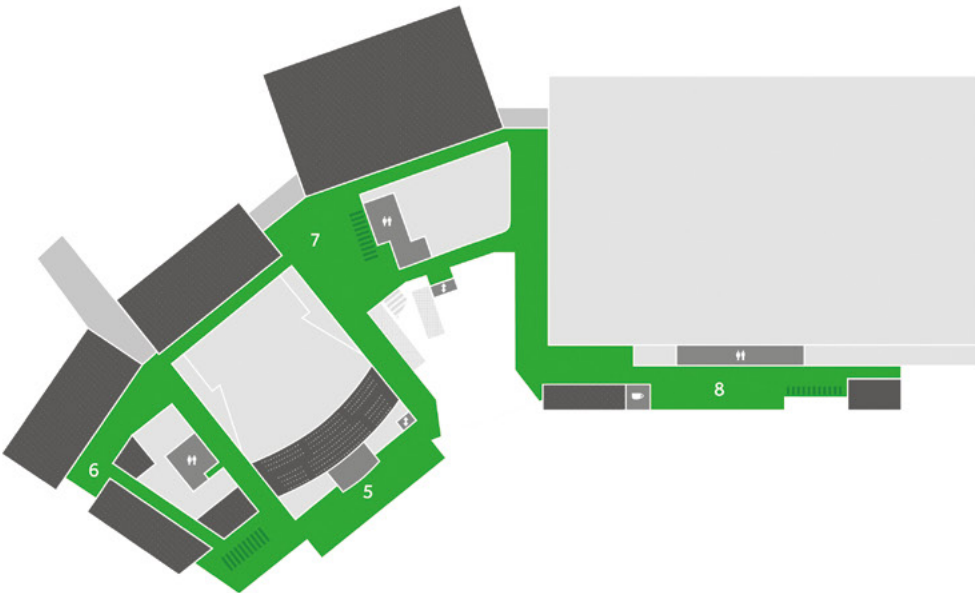

## GROUND FLOOR NETWORKING

ROOM	SIZE (square metres)
1. Atrium	800
2. Auditorium foyer	200
3. Main hall foyer	400
4. Outdoor plaza	2,500

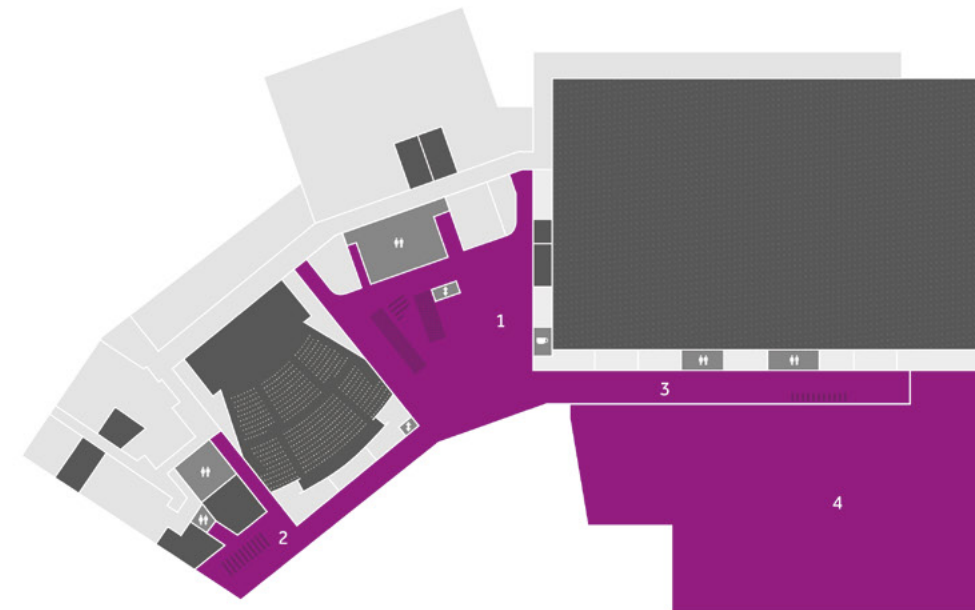



# BEHIND THE SCENES

- + Access from underground parking directly to atrium
- + 700 underground car parking spaces
- + Bag drop / luggage store
- + Cloakroom

## GREEN ROOMS

### -2 FLOOR GREEN ROOMS

ROOM	DIMENSIONS (m)	SIZE (square metres)
Green room A en suite	2.75 x 7.5	20.7
Green room B en suite	2.75 x 7.5	20.7

### GROUND FLOOR GREEN ROOMS

ROOM	DIMENSIONS (m)	SIZE (square metres)
Green room C / office en suite	5 x 8	36.7
Green room D / office	6.5 x 6	34.5
Green room E / office en suite	4.5 x 6.5	30.2
Green room F / office en suite	4.5 x 6.5	30.2



# LEADING TECHNOLOGY

## AUDIO VISUAL

- + Inclusive packages available
- + High speed fibre for supporting ultra HD video
- + Networked and traditional audio
- + Excellent client experience
- + Production / mixing and playback equipment including media server
- + HD cameras (both operator and automated)
- + Content management systems
- + Projection, screens and displays, including installed and deployable variants
- + High specification audio system
- + Live relay available to client and production offices

## EVENT-PRODUCTION LIGHTING

- + Control desks and distribution equipment
- + Production companies will use distribution systems which are installed in strategic locations throughout each room and key areas
- + A carefully selected inventory of stage-lighting control, luminaires, rigging accessories, cables and sundries will be provided

## BUILDING WIDE

- + Technical success for projects
- + Transportation of audio visual content throughout the building
- + Media content to be produced in one room and displayed with its corresponding audio in any breakout space

## WIFI

- + Dedicated team wifi
- + Hardwired connection for registration to support online delegate payments
- + Hardwired connection for two work stations
- + 5 Gigabit circuit and 1 Gigabit circuit (uncontested fibre) capable of being flexed together
- + Internal backbone network will be on a 10 Gigabit platform with full resilience
- + All front of house areas will have full wifi capability serviced by High Density Access Points
- + Copper and ISDN connections will also be provided by BT and Virgin Media
- + Internal mobile phone coverage will be serviced by Vodafone, EE and O2



Places to stay,  
people to see.

From quirky to  
international hotels and  
everything in between,  
we've got it covered.  
Here's a handful to get  
you started.

“After a hard day’s  
networking, we can  
recommend plenty  
of places to rest  
your head and  
refuel”

Danielle Bounds  
Sales Director  
ICC Wales



# ACCOMMODATION

All these hotels are within the local area and our team can help source bedrooms for you, and arrange transport to and from ICC Wales.

Hotel Name	* Rating	No. of Rooms	Distance from ICCW (miles)	Time by car (mins)
Holiday Inn Newport	3	119	0.5	5
Hunter Lodges	5	40	0.8	5
Coldra Court	4	148	0.8	5
Tŷ Hotel Langstone	3	154	0.8	5
Premier Inn Coldra	3	60	0.8	5
New Inn Hotel	3	34	2	5
The Priory	3	27	2	6
Mecure Chartist Tower	4	164	4	12
Newport Central Hotel By Hotel Fifty Five	3	60	4	12
Newport Student Village	2	200	5	12
Ibis Budget Newport	2	103	5	8
Days Inn Magor	3	39	5	8
Tŷ Hotel Magor	3	127	5	7
Parkway Cwmbran	4	80	7	12
Ramada Cwrt Bleddyn Hotel	3	46	7	15
Holiday Inn Express Newport	3	119	8	13
Newbridge on Usk	4	6	9	14
Premier Inn Cwmbran	3	48	9	14
Glen Yr Afon House Hotel	4	28	10	14
Three Salmons Hotel	3	24	10	14
St Mellons Hotel	3	20	11	18
St Pierre Marriott	4	148	11	19
Ibis Cardiff Gate	2	78	12	16
Premier Inn Cardiff North	3	147	13	17
Two Rivers Hotel	3	23	13	17
Cardiff North Hotel By Accor	3	146	14	20
The Beaufort, Raglan	3	18	14	15
Village Hotel Cardiff	3	118	17	20
Holiday Inn Cardiff North J32	3	95	17	20
Mercure Holland House	4	165	17	30
Llansantffraed Court Hotel	4	17	18	23
Radisson Blu	4	215	18	30
Clayton Hotel	4	216	18	30
Park Inn by Radisson City Centre	3	132	18	30
Premier Inn Cardiff South	3	98	18	30
Premier Inn Cardiff City Centre	3	200	19	30
Ibis City Centre	2	102	19	30
Novotel Cardiff	4	138	19	30
Ibis Budget Cardiff	2	157	19	30
Holiday Inn Express Cardiff Bay	3	87	19	30
Jurys Cardiff	4	142	19	30
Park Plaza	4	129	19	30
Hilton Cardiff	4	197	19	30
Indigo Hotel Cardiff	4	122	19	30
Number 10	4	21	19	30
Holiday Inn Cardiff City	4	157	19	30
Angel Hotel Cardiff	3	103	19	30
Marriott Cardiff	4	184	19	30
The Exchange	4	205	20	35
The St David's Hotel & Spa	5	142	21	33
Miskin Manor	4	43	23	27
Vale Resort	4	143	24	28
Copthorne Hotel	4	135	24	28





MIND  
BODY  
SOUL  
FOOD



“One cannot  
think well,  
love well,  
sleep well,  
if one has not  
dined well”

Virginia Woolf

**Our Culinary Philosophy**

ICC Wales is raising the benchmark with its innovative culinary thinking and is setting exciting new standards in outstanding conference catering with its Mind, Body and Soul Food philosophy.

We pride ourselves on offering our renowned warm Welsh welcome combined with world class quality cuisine. Our highly skilled, in-house culinary team have cooked for kings, queens and presidents and offer a comprehensive range of fantastic menus from kick-starting breakfasts and working lunches to refreshing tea breaks and sumptuous dinners.

- + Tasty Superfoods to nourish and invigorate
- + Using the finest local ingredients
- + High in protein and low in saturated fats to:
  - maintain energy
  - fight fatigue
  - sustain focus
- + Boosting alertness and concentration throughout conference day
- + Inspiring food served with our legendary Welsh hospitality



# LOCAL DINING OPTIONS

An abundance of dining variety within walking distance, with these seven exceptional restaurants providing a total of 950 covers.

All restaurants can also be used for private events, in addition to the numerous private dining rooms and unique alternative options available.

## THE RIB

Slow cooked, flavoursome Southern-inspired dishes.

130 covers



## RAFTERS

The finest Welsh produce and spectacular Usk Valley views.

120 covers



## STEAK ON SIX

Succulent signature steaks from around the British Isles.

72 covers



## NEWBRIDGE ON USK

Idyllic riverside country inn with delicious locally-sourced dishes.

80 covers



## THE OLIVE TREE

A bustling, vibrant atmosphere and sumptuous evening buffet.

300 covers



## PAD

Fresh, unique and truly inspired Asian cuisine.

120 covers



## THE GRILL

Relaxed clubhouse dining with awesome views.

150 covers



## FRIARS WALK

The place to come for a quick bite to eat or a meal to remember, great selection of bars and restaurants.



# LOCAL PRIVATE DINING

Private dining options  
available across the Celtic Manor Collection

- + The Olive Tree Private Dining Room - 28 persons
- + PAD Private Dining Room - 20 persons
- + Hedleys - 50 persons
- + Isca Suite - 30 persons
- + Albert Matthews Suite - 40 persons
- + Samuel Ryder Suite - 96 persons
- + Rooftop Garden Barbecue Terrace - 120 persons

PAD PRIVATE  
DINING ROOM  
20 persons



ROOFTOP  
TERRACE  
120 persons



HEDLEYS  
50 persons



ISCA SUITE  
30 persons



THE OLIVE TREE  
PRIVATE  
DINING ROOM  
28 persons



SAMUEL  
RYDER SUITE  
96 persons



ALBERT  
MATTHEWS  
SUITE  
40 persons





Iconic,  
modern  
Wales.

Rich in history and beautiful  
landscapes, Wales offers  
an idyllic setting for a  
memorable convention.

“These venues  
support large  
conventions  
and provide  
unique and  
memorable  
backdrops for  
dinner and  
special events”

Leon Hughes  
Head of Event Management  
ICC Wales



# OFF SITE DINING VENUES

Venue	Maximum Banquet Capacity	Distance to ICC Wales
Motorpoint Arena	1,200	21 miles
Cardiff City Stadium	550	20 miles
Cardiff City Hall	500	21 miles
St Fagans National Museum of History	350	24 miles
National Museum Cardiff	320	21 miles
Chepstow Racecourse	300	14 miles
Principality Stadium	300	21 miles
St David's Hall	300	21 miles
Welsh College of Music & Drama	200	21 miles
Cardiff Castle	150	21 miles
Riverfront Newport	100	5 miles



# GETTING HERE

We may be surrounded by fresh mountain air, but we're a stone's throw from the M4, Cardiff and Bristol airports and are well connected to mainline train stations.

 CAR to ICC Wales	TIME	DISTANCE Miles
Cardiff	23 mins	14
Bristol	40 mins	31
Birmingham	1hr 50mins	105
London	2hr 30mins	138
Manchester	3hr	170

 TRAIN*	TIME
Birmingham	1hr 52 mins
Bournemouth	3hr 17 mins
Brighton	3hr 57 mins
Bristol	33 mins
Cardiff	13 mins
Carmarthen	2hr 8 mins
Exeter	2hr 12 mins
Gatwick	3hr 1 mins
Heathrow	2hr 29 mins
Leeds	4hr 5 mins
Liverpool	4hr 3 mins
London (Paddington)	1hr 47 mins
Manchester	3hr 26 mins
Newcastle	5hr 41 mins
Nottingham	3hr 12 mins
Oxford	2hr 2 mins
Southampton	2hr 17 mins
Stoke-On-Trent	3hr
Swansea	1hr 11 mins
York	4hr 27 mins

 PLANE	TIME	AIRLINE
Aberdeen International to Bristol	1hr 20 mins	Logan Air
Belfast International to Bristol	1hr 5 mins	Easyjet
Dublin to Bristol	1hr 10 mins	Ryanair
	1hr 10 mins	Aer Lingus
Dublin to Cardiff	1 hr	Flybe & Aer Lingus
Edinburgh to Cardiff	1 hr 5 mins	Flybe
Edinburgh to Bristol	1 hr 10 mins	Easyjet
Glasgow to Bristol	1 hr 10 mins	Easyjet
Newcastle International to Cardiff	1hr 15 mins	Eastern Airways

Driving distances from train station to ICC Wales

STATION	TIME
Newport	12 mins

Driving distances from airports to ICC Wales

AIRPORT	TIME
Cardiff	40 mins
Bristol	40 mins
Birmingham	1hr 30mins
Heathrow	1hr 45mins
Manchester	3hr 15mins



\* All rail services arrive into Newport station and are an indication of travel at peak times. Earlier services are available for some routes.



# WHY WALES?

A VERY WARM WELCOME

Warm welcomes are exactly what you get when you visit Wales. We're all about the people and we're told that our warmth of hospitality at our conventions make this place somewhere really special to host an event.

- + New facility, bespoke built for conventions
- + Fresh air, fine food and warm welcomes
- + Plentiful on-site parking
- + Flexible layouts with the option to grab a coffee or a quick walk in the surrounding woodland
- + Passionate, experienced teams that are ready to serve
- + World-class facility
- + Accessible
- + Safe city



## MAKE IT HAPPEN TEAM



**Ian Edwards**  
Chief Executive  
ian.edwards@iccwales.com  
01633 410 200



**Jill Manley**  
Commercial Director  
jill@iccwales.com  
01633 410 200



**Nancy Mollett**  
Convention Centre Director  
nancy@iccwales.com  
01633 410 200



**Danielle Bounds**  
Sales Director  
danielle@iccwales.com  
01633 410 200  
07918 630 467



**Gemma Savage**  
Association Sales Manager  
gemma@iccwales.com  
07879 621061



**Kathryn Tighe**  
Sales Manager  
kathryn@iccwales.com  
07879 664710



**Leon Hughes**  
Head of Event Management  
leon@iccwales.com  
01633 410 200  
07899 913 651



**Helena Johnson**  
Sales Executive  
helena@iccwales.com  
01633 410 200



**Cerys Davey**  
Liaison Officer  
cerys@iccwales.com  
07917 433 561

We look forward to welcoming you or as we say in Wales, Croeso (said Croy-so)





“Countryside,  
convenience  
& creativity.  
What more  
would you  
expect from  
a small yet  
clever country”

Sir Gareth Edwards CBE  
Wales & British Lions Rugby Legend



Let's go. Book now.  
01633 410 200

Version 5



01633 410 200  
leadtheway@iccwales.com  
ICC Wales, Coldra Woods, Newport NP18 1HQ

in t f i  
#leadtheway