

NETWORKING SPACES

International Convention Centre Wales

iccwales.com

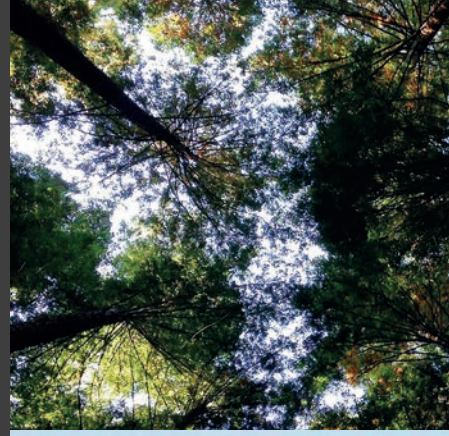

NETWORKING SPACES

GROUND FLOOR, FIRST FLOOR & SECOND FLOOR

Take a breath of fresh air and discover
a stunning venue surrounded by woodland

- + Outdoor areas and adjacent woodland on all levels
- + 2,500 sqm of outdoor plaza space for outdoor exhibitions, networking and breakouts
- + Welcoming and generous plaza entrance
- + Versatile breakout areas from all the central spaces
- + Spacious and impressive atrium and lobby spaces
- + 500 sqm lounge overlooking main atrium, the perfect space for thinking



SECOND FLOOR NETWORKING

ROOM	SIZE (square metres)
9. The lounge	500

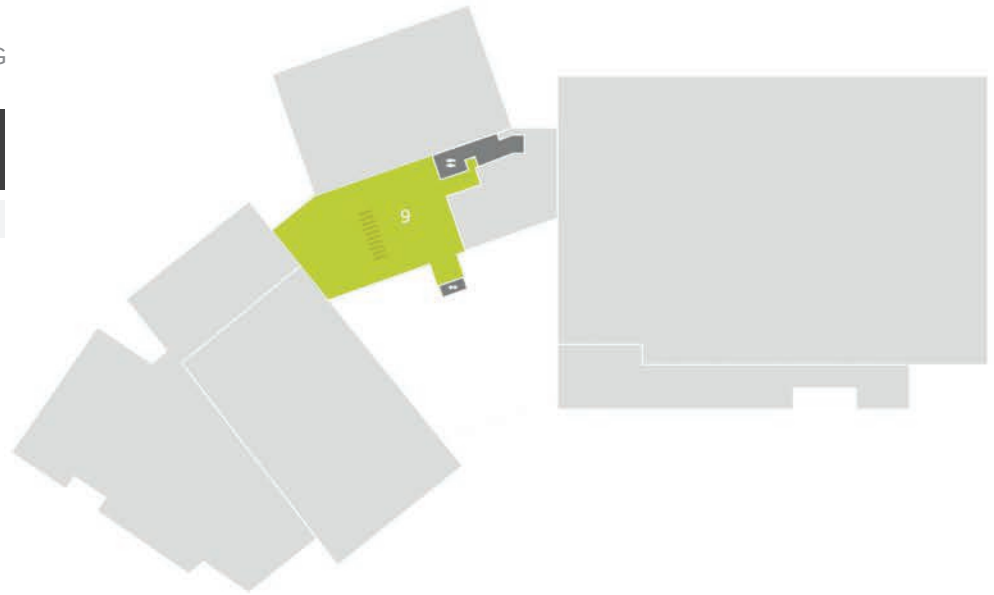

FIRST FLOOR NETWORKING

ROOM	SIZE (square metres)
5. Aspect bar	210
6. Meeting room breakout	200
7. Meeting room 1 foyer	450
8. Plaza view foyer	360

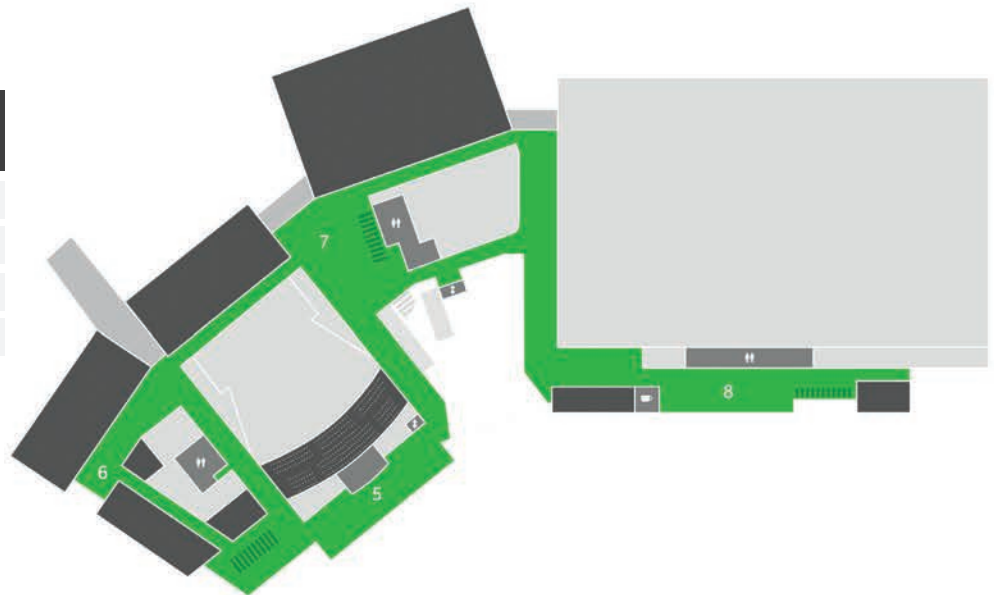

GROUND FLOOR NETWORKING

ROOM	SIZE (square metres)
1. Atrium	800
2. Auditorium foyer	200
3. Main hall foyer	400
4. Outdoor plaza	2,500



GROUND FLOOR

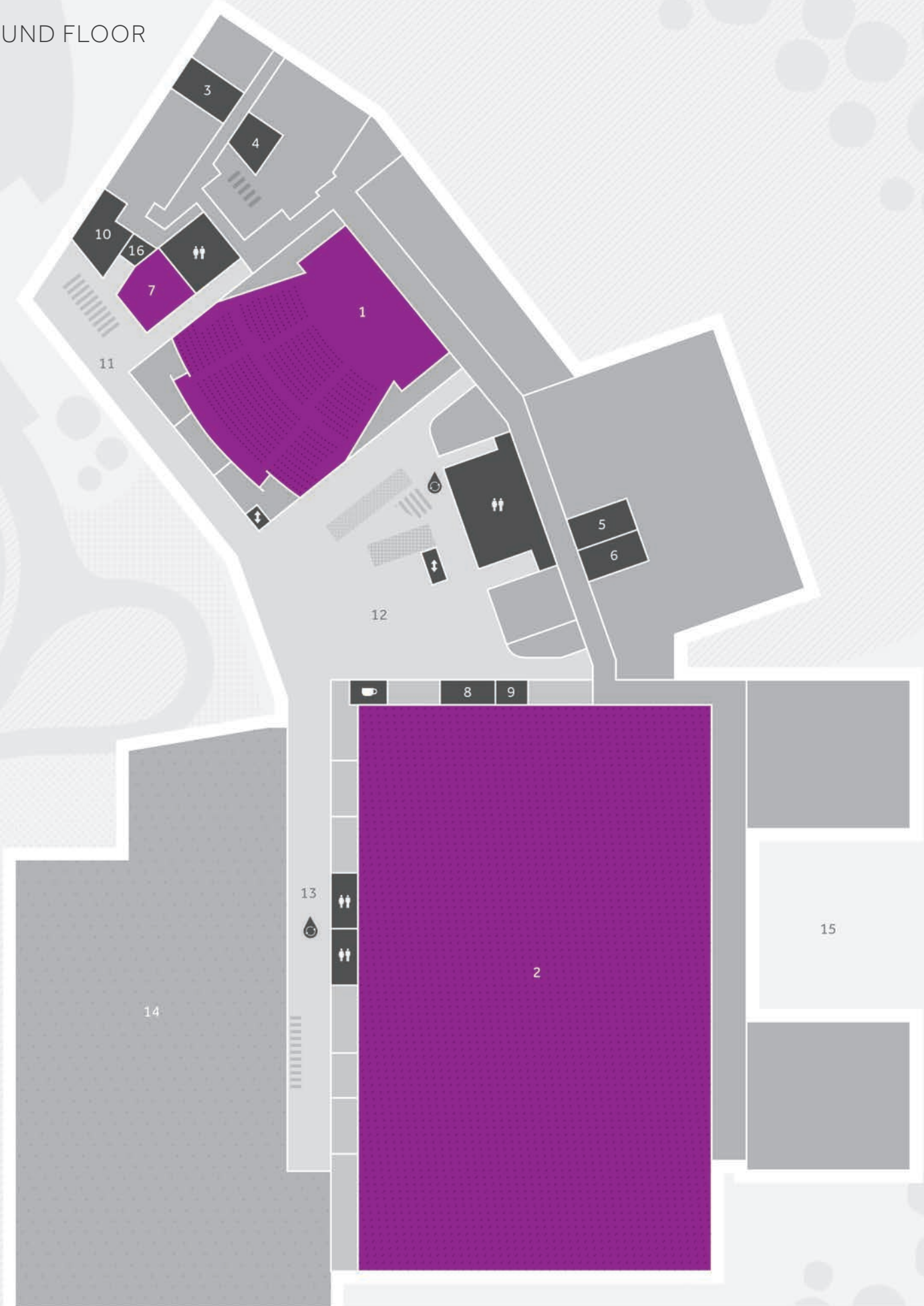

- | | | | |
|---|----------------|----|------------------------|
| 1 | Auditorium | 9 | Medical room |
| 2 | Main hall | 10 | Business centre |
| 3 | Green room C | 11 | Auditorium foyer |
| 4 | Green room D | 12 | Atrium |
| 5 | Green room E | 13 | Main hall foyer |
| 6 | Green room F | 14 | Outdoor plaza |
| 7 | Meeting room 7 | 15 | Loading bay |
| 8 | Office | 16 | Changing places toilet |

- ♿ Toilets
- ☕ Coffee shop
- ⬆ Lift
- ||| Stairs
- ▤ Escalator
- 💧 Water refill station

FIRST FLOOR

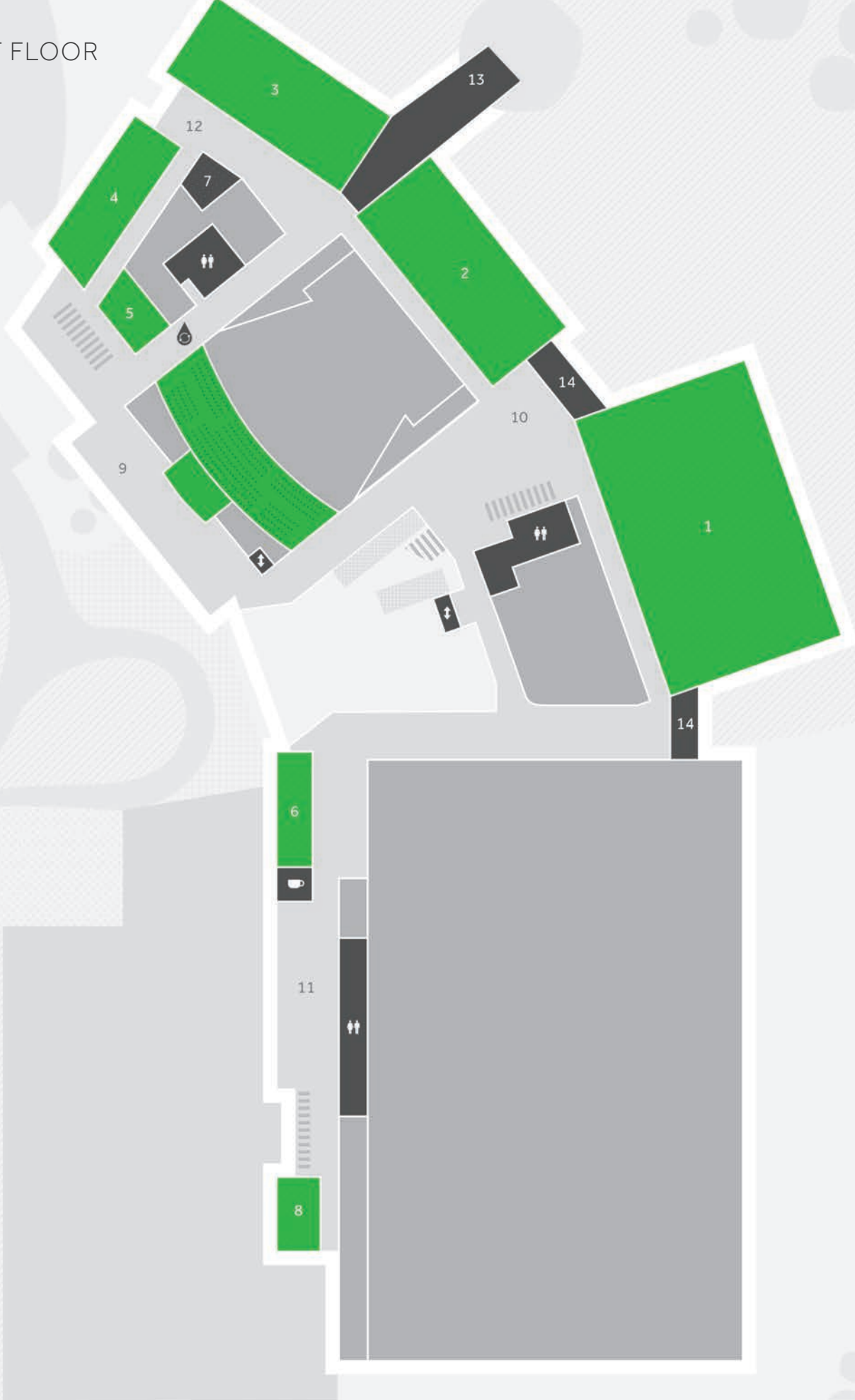

- 1 Meeting room 1
- 2 Meeting room 2
- 3 Meeting room 3
- 4 Meeting room 4
- 5 Meeting room 5
- 6 Meeting room 6
- 7 Client office

- 8 Executive boardroom
- 9 Aspect bar
- 10 Woodland suite foyer
- 11 Plaza view foyer
- 12 Meeting room breakout
- 13 Woodland access
- 14 Outdoor terrace

- ♠ Toilets
- ☕ Coffee shop
- ↑↓ Lift
- ||| Stairs
- ▤ Escalator
- 💧 Water refill station

SECOND FLOOR

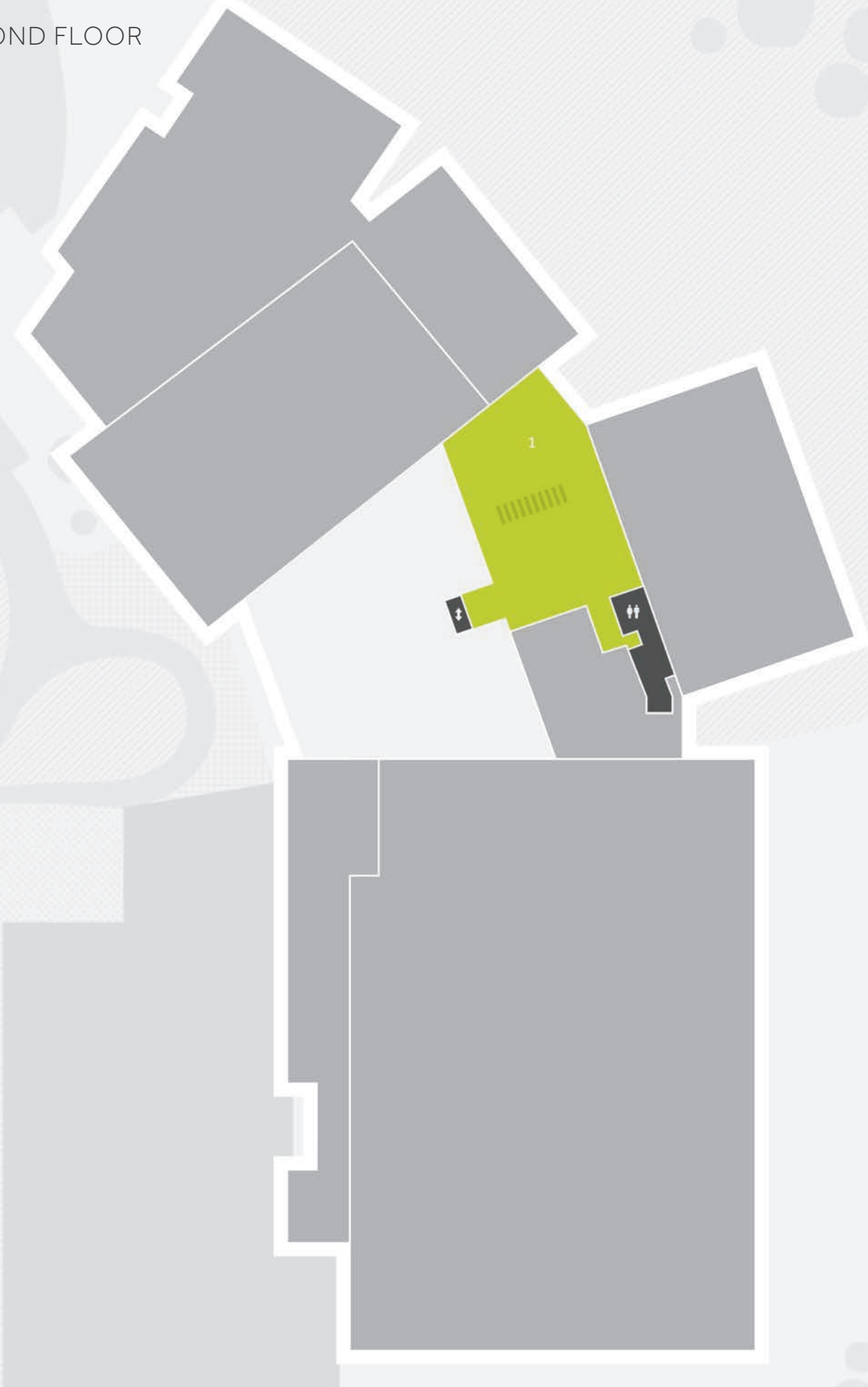

- 1 The Lounge
- ♂♀ Toilets
- ↑↓ Lift
- ||| Stairs