

FLOORPLANS & CAPACITIES



International Convention Centre Wales

iccwales.com



GROUND FLOOR

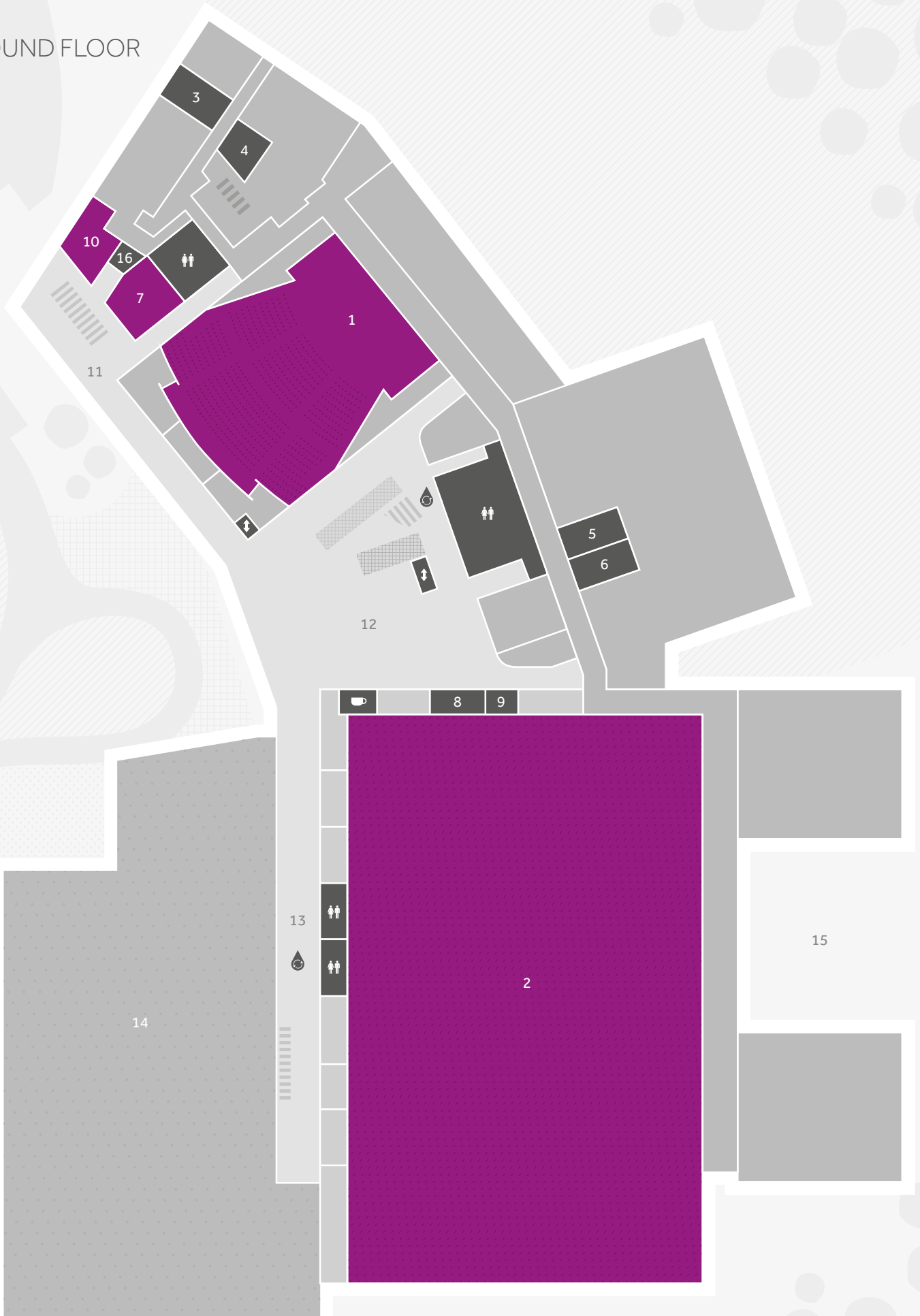

- 1 Auditorium
- 2 Main hall
- 3 Green room C
- 4 Green room D
- 5 Green room E
- 6 Green room F
- 7 Meeting room 7
- 8 Office

- 9 Medical room
- 10 Meeting room 8
- 11 Auditorium foyer
- 12 Atrium
- 13 Main hall foyer
- 14 Outdoor plaza
- 15 Loading bay
- 16 Changing places toilet

- ♂/♀ Toilets
- ☕ Coffee shop
- ↑/↓ Lift
- Stairs
- Escalator
- 💧 Water refill station

FIRST FLOOR

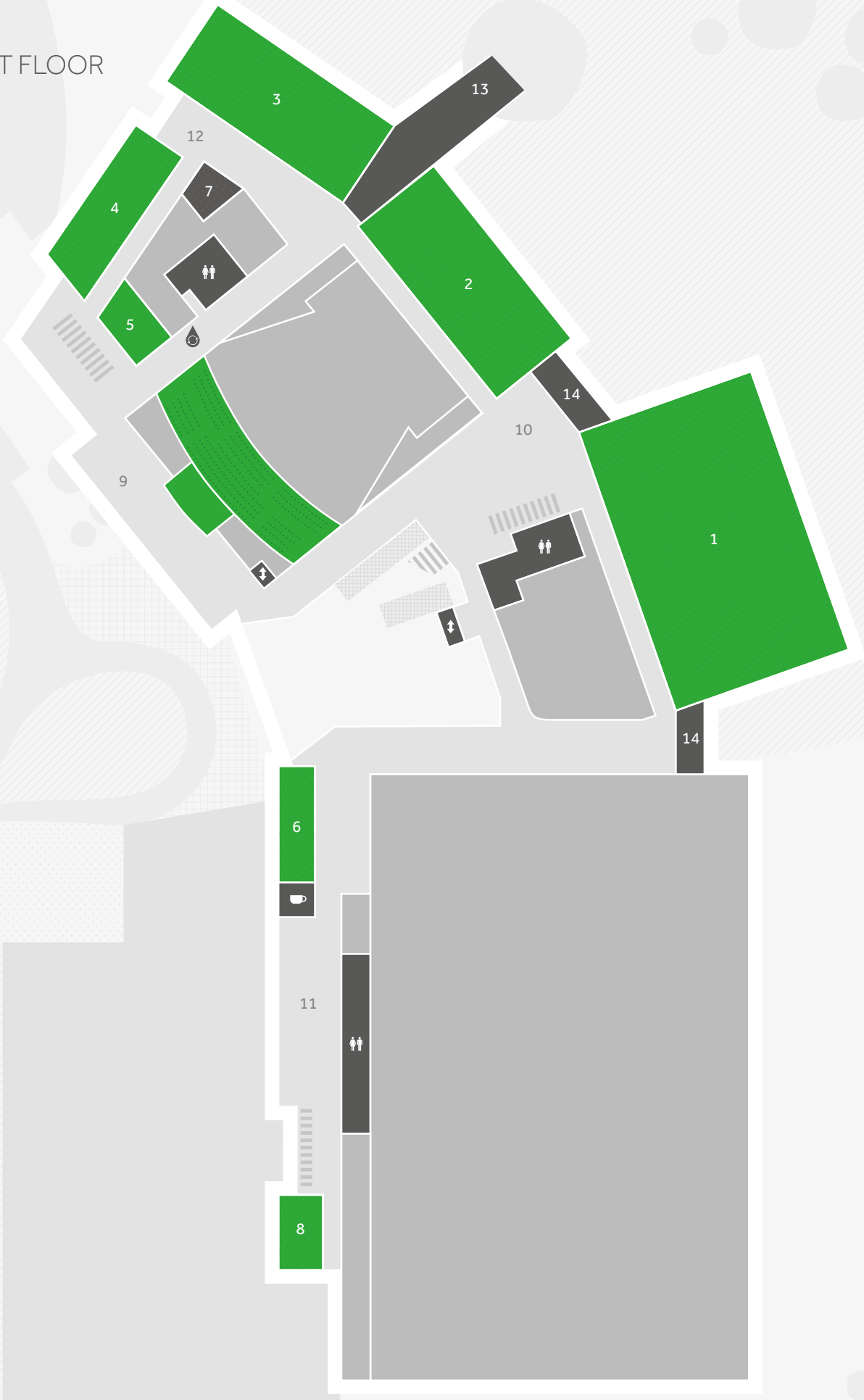

- 1 Meeting room 1
- 2 Meeting room 2
- 3 Meeting room 3
- 4 Meeting room 4
- 5 Meeting room 5
- 6 Meeting room 6
- 7 Client office

- 8 Executive boardroom
- 9 Aspect bar
- 10 Woodland suite foyer
- 11 Plaza view foyer
- 12 Meeting room breakout
- 13 Woodland access
- 14 Outdoor terrace

- Toilets
- Coffee shop
- Lift
- Stairs
- Escalator
- Water refill station

SECOND FLOOR

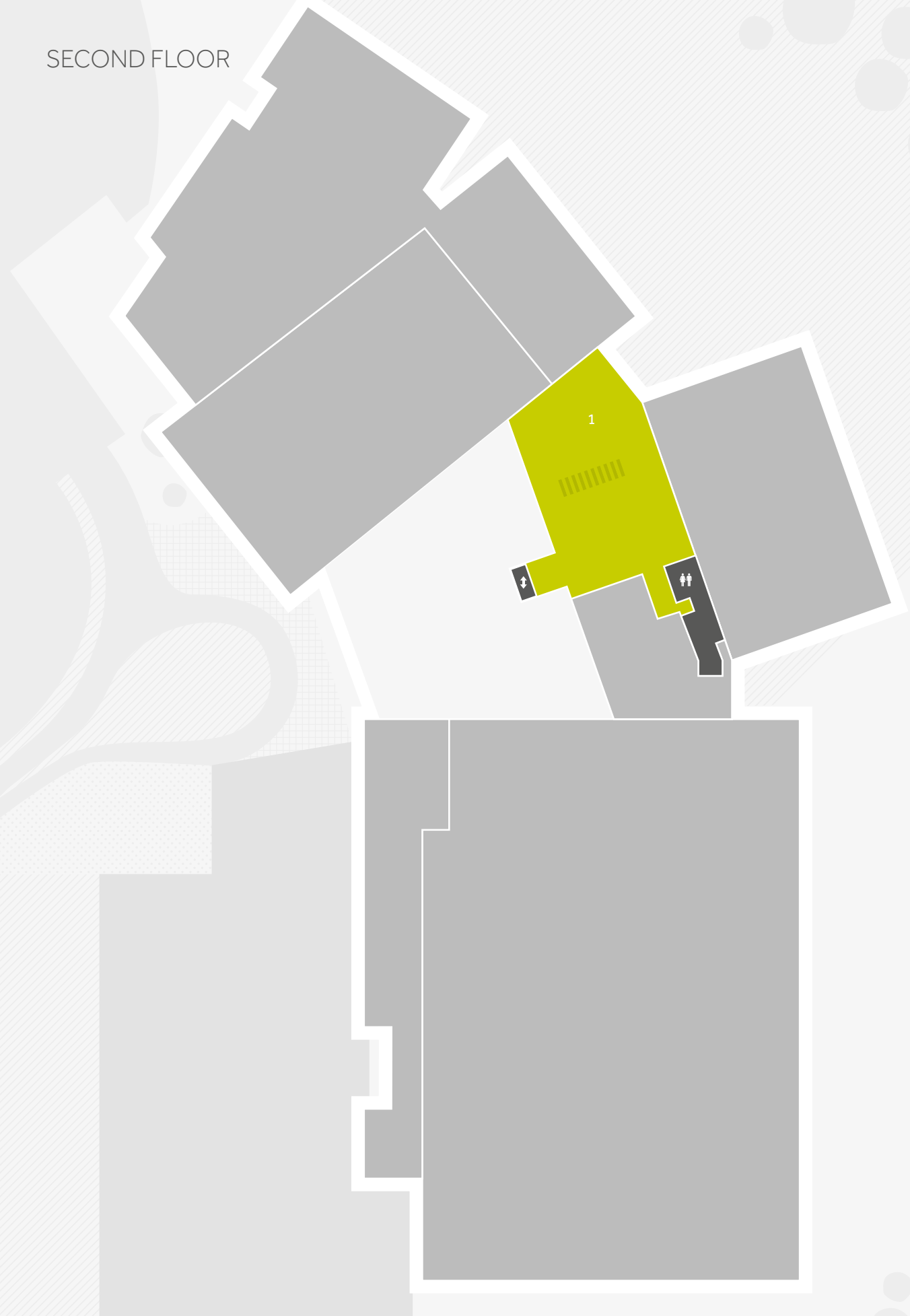

- 1 The Lounge
- Toilets
- Lift
- Stairs

FLOOR -1

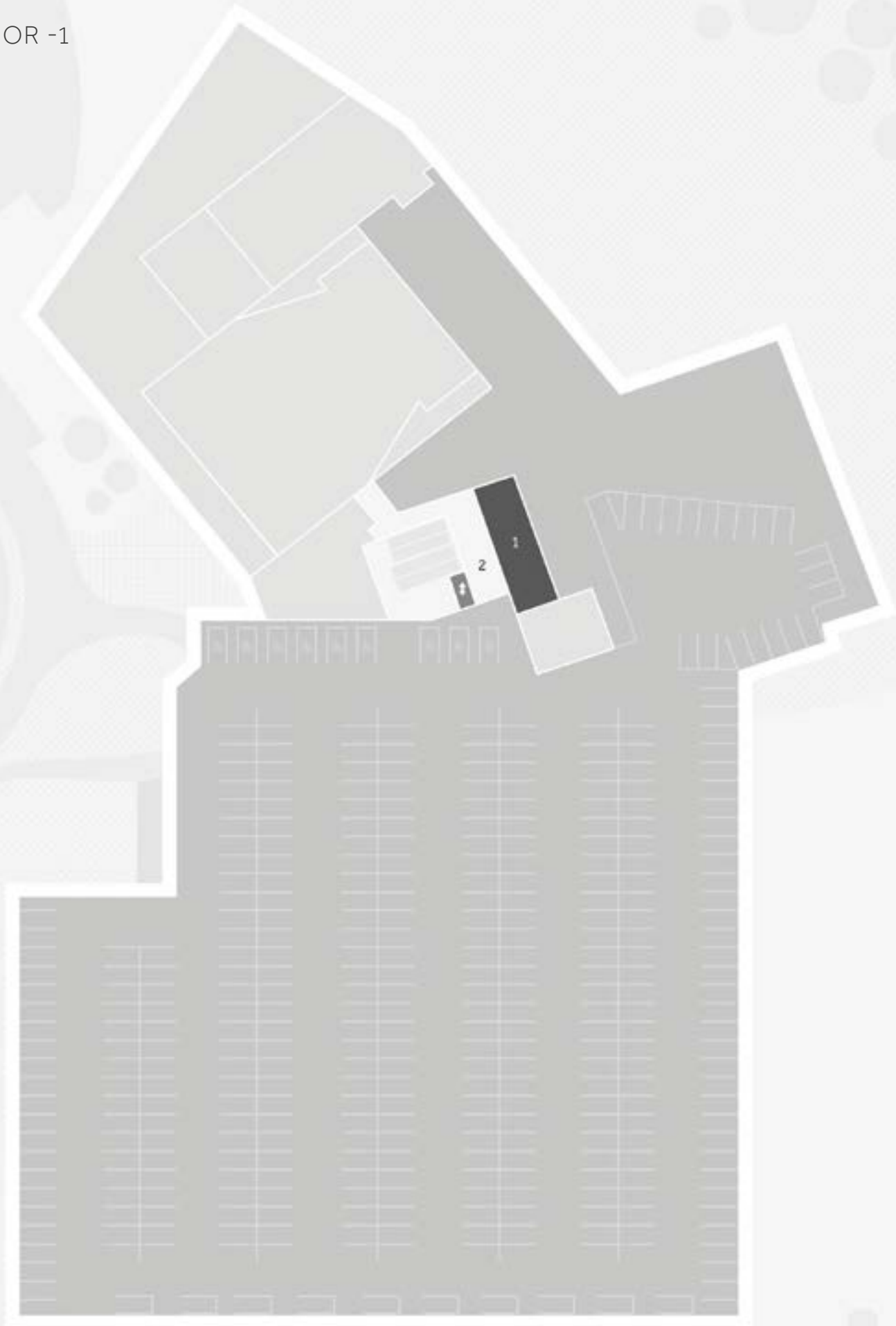

- 1 Cloakroom
- 2 Access from underground parking
- ⇕ Lift
- Escalator

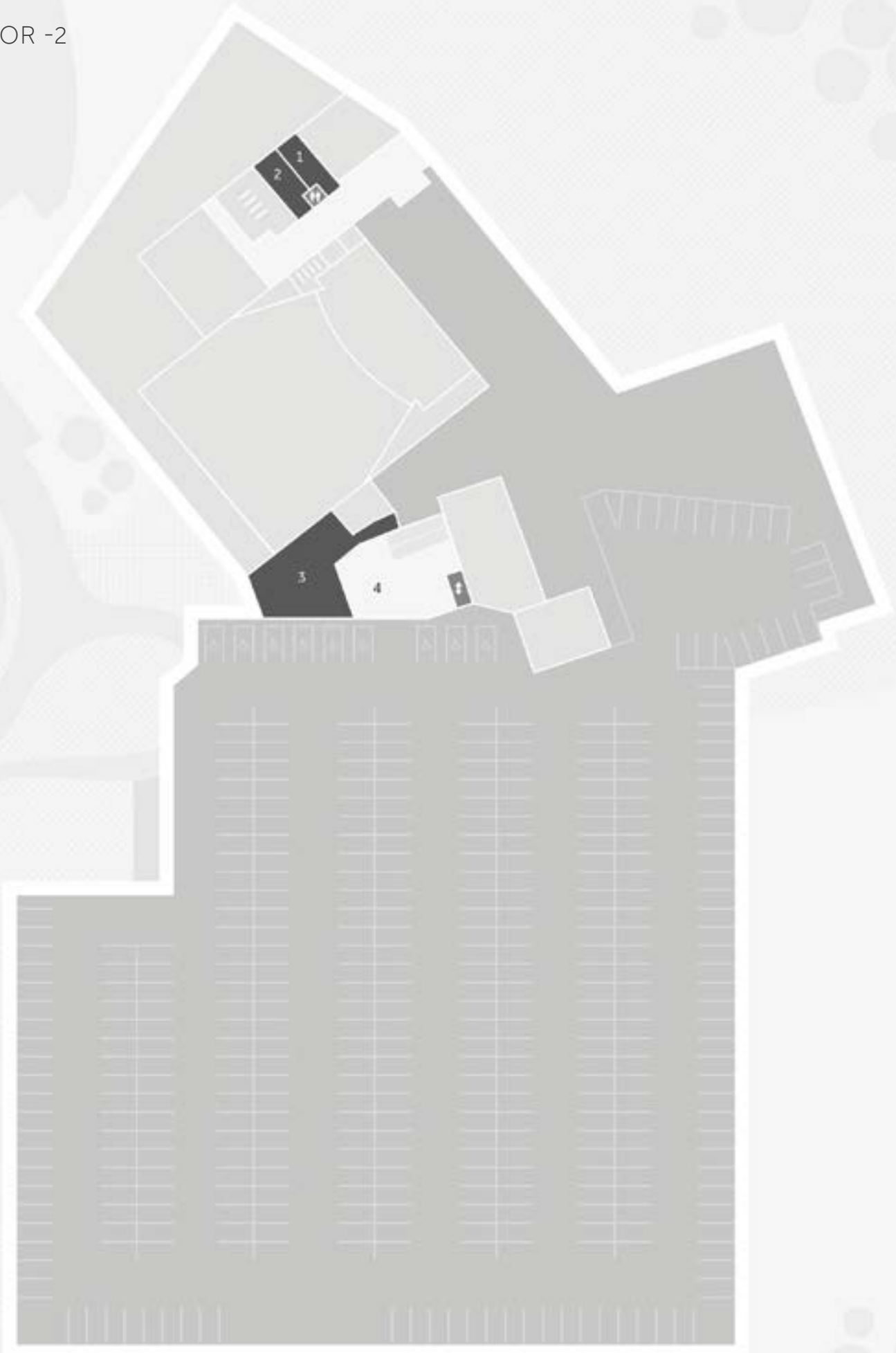

- 1 Green room A
- 2 Green room B
- 3 Bag drop / luggage store
- 4 Access from underground parking

- ⇄ Toilets
- ⬆ Lift
- ||| Stairs
- ||| Escalator

Room	Level Access	Divisible Sections	Dimensions (m)	Size (sqm)	Theatre	Cabaret tables of 8 with standard stage only	Banquet tables of 10 without stage or dance floor
Main hall	Ground	All	80 x 50	4000	4100	2464	3080
		A (1/3)	32 x 50	1600	1650	896	1120
		B (1/3)	24 x 50	1200	1235	784	980
		C (1/3)	24 x 50	1200	1235	784	980
		D (2/3)	56 x 50	2800	2855	1680	2100
		E (2/3)	48 x 50	2400	2475	1456	1960
		F (1/2)	40 x 50	2000	2050	1232	1540
		G (1/2)	40 x 50	2000	2050	1232	1540
		H (1/4)	25 x 40	1000	1030	616	770
		I (1/4)	25 x 40	1000	1030	616	770
		J (1/4)	25 x 40	1000	1030	616	770
		K (1/4)	25 x 40	1000	1030	616	770
		L	32 x 25	800	825	448	560
		M	32 x 25	800	825	448	560
		N	24 x 33	792	820	432	540
		O	24 x 17	408	420	192	240
		P	24 x 25	600	620	336	420
		Q	24 x 25	600	620	336	420
		R (half 2/3)	48 x 25	1200	1235	784	980
		S (half 2/3)	48 x 25	1200	1235	784	980
		T (half 2/3)	56 x 25	1400	1440	840	1050
		U (half 2/3)	56 x 25	1400	1440	840	1050
		V (1/2 length)	80 x 25	2000	2050	1232	1540
		W (1/2 length)	80 x 25	2000	2050	1232	1540
		X	24 x 25	600	620	336	420
		Y	24 x 25	600	620	336	420
		Auditorium	Ground & First	All			1500
Upper					762	n/a	n/a
Lower					738	n/a	n/a
Meeting room 1 (Woodland suite)	First	All	38 x 23	874	900	432	660
		1A	12.5 x 23	287	300	112	170
		1B	12.5 x 23	287	300	112	170
		1C	12.5 x 23	287	300	112	170
		1D	19 x 23	437	450	184	280
		1E	19 x 23	437	450	184	280
		1F	25 x 23	575	600	304	390
		1G	25 x 23	575	600	304	390

MEETING ROOMS

	Room	Level Access	Divisible Sections	Dimensions (m)	Size (sqm)	Theatre	Cabaret tables of 8 with standard stage only	Banquet tables of 10 without stage or dance floor
MEETING ROOMS	Meeting room 2	First	All	29 x 12.5	362.5	370	192	260
			2A	9.5 x 12.5	112.5	110	56	70
			2B	9.5 x 12.5	112.5	110	62	70
			2C	9.5 x 12.5	112.5	110	56	70
			2D	14 x 12.5	175	180	96	120
			2E	14 x 12.5	175	180	96	120
			2F	20 x 12.5	250	260	120	150
			2G	20 x 12.5	250	260	120	150
	Meeting room 3	First	All	28 x 12	336	340	192	260
			3A	9 x 12	108	100	48	60
			3B	9 x 12	108	100	48	60
			3C	9 x 12	108	100	48	60
			3D	14 x 12	170	160	96	120
			3E	14 x 12	170	160	96	120
			3F	19 x 12	240	240	120	150
	Meeting room 4	First	All	20 x 7.5	153.5	150	80	100
			4A	10.5 x 7.5	78.5	65	40	n/a
			4B	9.5 x 7.5	71	65	40	n/a
	Meeting room 5	First		8 x 6	53	30	n/a	n/a
	Meeting room 6 en suite	First		11 x 4.5	56.8	30	n/a	n/a
Meeting room 7	Ground		8.25 x 8	66	45	n/a	n/a	
Meeting room 8	Ground		6.5 x 7.5	43.5	30	n/a	n/a	
Executive boardroom	First		9 x 5.5	51.4	n/a	n/a	n/a	
ADDITIONAL SPACES	Office	First		5 x 3	22.1	n/a	n/a	n/a
	Main hall office	Ground		9 x 2	18	n/a	n/a	n/a
	Green room A en suite	-2		2.75 x 7.5	20.7	n/a	n/a	n/a
	Green room B en suite	-2		2.75 x 7.5	20.7	n/a	n/a	n/a
	Green room C / office en suite	Ground		5 x 8	36.7	n/a	n/a	n/a
	Green room D / office	Ground		6.5 x 6	34.5	n/a	n/a	n/a
	Green room E / office en suite	Ground		4.5 x 6.5	30.2	n/a	n/a	n/a
	Green room F / office en suite	Ground		4.5 x 6.5	30.2	n/a	n/a	n/a
NETWORKING SPACES	Atrium	Ground			800			
	Auditorium foyer	Ground			200			
	Main hall foyer	Ground			400			
	Outdoor plaza	Ground		71 x 34	2414			
	Aspect bar	First			210			
	Meeting room breakout	First			200			
	Meeting room 1 foyer	First			450			
	Aspect view foyer	First			360			
	The lounge	Second			500			